



SARSILMAZ[®]

SEMI-AUTOMATIC PISTOLS



**USE AND MAINTENANCE MANUAL
& SPARE PARTS LIST**

MODEL

- B6
- B6C

- CM9
- CM9-GEN2
- P8L
- P8S
- K2
- K2C
- K2-45
- K2-45 C
- K12
- K12 SPORT
- KILINÇ 2000 LIGHT
- KILINÇ 2000 MEGA

SUB MODEL

- (9x19 mm)
- (9x19 mm)
- (9x17 mm)
- (7,65 mm)
- (.22 LR)
- (9x19 mm)
- (9x19 mm)
- (9x19 mm)
- (9x19 mm)
- (9x19 mm)
- (9x19 mm)
- (.45 AUTO)
- (.45 AUTO)
- (9x19 mm)
- (9x19 mm)
- (9x19 mm)
- (9x19 mm)

Semi-Automatic Pistols

⚠ WARNING

SARSILMAZ disclaims any and all liability arising out of the use of any SARSILMAZ products (i) contrary to instructions or regulations; (ii) without caution; (iii) by any parties other than the license holder; (iv) through making unauthorized or illegal modifications thereon; (v) utilizing non-standard or out of spec cartridges; (vi) under maintenance or repair services rendered by unauthorized persons; or (vii) under any similar conditions whatsoever. SARSILMAZ excludes all liability for any injuries or property damages arising from the malicious or negligent use of products.

⚠ WARNING

All pictures, photos and definitions in this manual are provided only for information purposes. Manufacturer reserves its right to apply changes to any models any time without prior notice as deemed necessary for improving the products or in line with any manufacturing or commercial requirements.

BEING MANUFACTURED WITH THE ASSURANCE OF INDUSTRIAL
QUALITY CONTROL CERTIFICATE IN TURKEY TS EN ISO
9001:2008
QUALITY CERTIFICATE
AND TSE MANUFACTURING SUFFICIENCY CERTIFICATE

SARSILMAZ®

IS A POWER BRAND

CONTENTS

1. GENERAL PRECAUTIONS.....	6	6. MAINTENANCE AND CLEANING	27
2. GENERAL RULES FOR SAFETY	7	6.1. MAINTENANCE AND CLEANING KIT.....	27
3. PRODUCT AND FEATURES IDENTIFICATION.....	10	6.2. DISASSEMBLING YOUR FIREARM	27
3.1. SUPPLIED COMPONENTS	10	6.3. MAINTENANCE AND CLEANING OF YOUR FIREARM	29
3.2. MAIN PRODUCT FEATURES	10	6.4. REASSEMBLING OF YOUR FIREARM.....	30
3.3. BASIC PARTS.....	11	6.5. INSPECTION OF FUNCTIONS.....	31
3.4. ADDITIONAL FEATURES.....	12	6.6. MAINTENANCE OF YOUR MAGAZINE	32
3.5. TECHNICAL DATA and FEATURES.....	13	6.6.2. CLEANING YOUR MAGAZINE.....	33
4. PUTTING YOUR PRODUCT INTO SERVICE.....	16	6.6.1. DISASSEMBLING YOUR MAGAZINE	32
4.1. PRELIMINARY PREPERATION.....	16	6.6.3. REASSEMBLING THE MAGAZINE	33
4.2. INSPECTING YOUR PISTOL.....	16	7. TROUBLESHOOTING.....	34
4.3. AMMUNITION	18	8. EXPLODED WIEVS and PART LISTS	36
4.4. FIRING	19	8.1. B6 EXPLODED WIEV	36
4.4.3. ASSEMBLING YOUR FIREARM.....	20	8.2. B6C EXPLODED WIEV	38
4.4.1. CHECKS AND SAFETY BEFORE FIRING	19	8.3. CM9 EXPLODED WIEV	40
4.4.5. FIRING	21	8.4. CM9-GEN2 EXPLODED WIEV	42
4.4.2. LOADING YOUR MAGAZINE	19	8.5. P8L EXPLODED WIEV	44
4.4.6. RELOADING YOUR PISTOL	22	8.6. P8S EXPLODED WIEV	46
4.4.4. SETTING YOUR LINE OF FIRE.....	21	8.7. K2 EXPLODED WIEV	48
4.4.7. UNLOADING YOUR FIREARM	22	8.8. K2C EXPLODED WIEV	50
4.5. SECURING YOUR FIREARM.....	23	8.9. K2-45 EXPLODED WIEV	52
4.5.2. RELEASING YOUR HAMMER SAFELY	24	8.10. K2-45 C EXPLODED WIEV.....	54
4.5.1. UNLOADING WHILE MAGAZINE AND BARREL ARE LOADED WITH CARTRIDGES	23	8.11. K12 EXPLODED WIEV.....	56
5. ADJUSTMENTS	26	8.12. K12 SPORT EXPLODED WIEV	58
5.1. ADJUSTMENT OF SIGHTS.....	26	8.13. KILINÇ 2000 LIGHT EXPLODED WIEV.....	60
		8.14. KILINÇ 2000 MEGA EXPLODED WIEV	62

1. GENERAL PRECAUTIONS

Read the instructions and warnings in this manual carefully before handling SARSILMAZ products for any purposes.

As a prerequisite for the putting of SARSILMAZ products into service and the safety requirements in their use, cleaning and maintenance, you must be familiar with and follow exactly all information provided in this manual. Please do not use the product unless you read the instructions for safety and use thoroughly and carefully. If you need any further information please consult your dealer or the factory.

Please observe the laws of your region or your country governing the purchasing, handling and use of firearms.

All firearms are dangerous. Therefore, your product is sold to you provided that you comply with all instructions for use and SARSILMAZ disclaims in advance any and all responsibility for any technical damage or other consequences whatsoever that may be caused by the misuse of the product, including any harm or injury or property damage arising in relation to the following,

- Always keep the muzzle pointed in a safe direction.
- Firearms should be unloaded and secured when not actually in use.
- Do not rely on your firearm's safety.
- Be sure of your target and what's beyond it.
- Make sure that your ammunition matches the caliber or gauge of your gun.
- If your pistol fails to fire when the trigger is pulled, handle with care.
- It is your responsibility to ensure that you are in compliance with all applicable laws and ordinances regarding the use of your firearm.
- Other factors directly or indirectly of beyond our control.

2. GENERAL RULES FOR SAFETY

2.1. ALWAYS KEEP YOUR FIREARM POINTED IN A SAFE DIRECTION.

Never point a firearm at yourself or anyone. This is particularly important when loading or unloading the gun. Always control what is behind your target. If you miss or hit your target, it is your responsibility to ensure your shot will not cause unexpected injuries or damages.

2.2. ALWAYS TREAT EVERY FIREARM AS IF IT IS LOADED.

Do not take anyone's word that the firearm is unloaded – always check for yourself. Keep mind that your firearm is ready to fire unless you are fully convinced that the firearm is unloaded and safely stored.

2.3. HIDE YOUR GUN OUT OF CHILDREN'S SIGHT.

It is your responsibility that your firearm is not accessible to children under 18 and/or other unauthorized persons. You must always store your firearm unloaded and secured with ammunition stored separately in order to minimize the risk of accidents involving children.

2.4. NEVER SHOOT AT HARD SURFACES OR WATER.

Shooting at water or hard surfaces cause changes in the direction of the cartridges which results in the injury of your own or others.

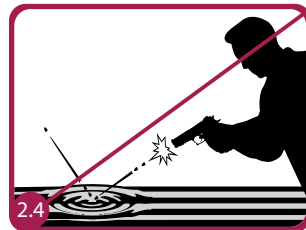
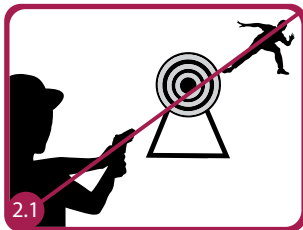
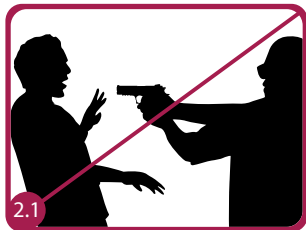

2.5. NEVER USE ALCOHOL OR DRUGS THAT MAY IMPAIR MENTAL OR PHYSICAL ABILITY BEFORE SHOOTING.

Do not use your firearm if you are drunk or on any medication which impairs your mental or physical ability.

2.6. FOLLOW PROPER MAINTENANCE PROCEDURES FOR YOUR FIREARM

In order to prevent accumulation of dirt or dust on the operating parts, store your firearm in its original case. Since you will need your gun in emergencies, lubricate and clean your gun after every use following the instructions in order to avoid any corrosion, barrel damage and dirt. Before loading the barrel always check it is completely clean (completely free from any obstructions such as dirt, mud, oil, ammunition or ammunition residuals). Shooting against an obstruction can cause an increase in pressure and may damage your gun and cause injury to yourself and others. The operation of your handgun has changed the way it sounds, stop firing and make sure the firearm is pointed in a safe direction and unload the firearm. Check the chamber and barrel bore for any failure to use the correct type or caliber of ammunition that may cause the firearm to jam.

2.7. USE PROPER AMMUNITION.

Only use factory-loaded ammunition that is newly manufactured within industrial specifications. Ensure all cartridges to be used are compatible with the caliber and type of your gun. Avoid using MP5 bullets!

2.8. ALWAYS WEAR SAFETY GLASSES AND EAR PROTECTORS SPECIFIED FOR FIREARM USE.

Shooter should always wear impact-resistant safety glasses and ear protectors to prevent damage to hearing due to firing when using any firearms.

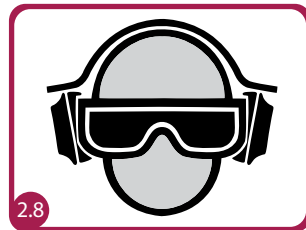
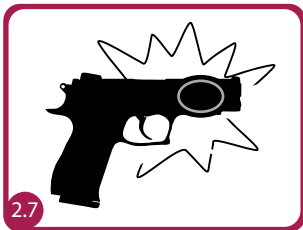

2.9. OBSERVE THE RULES!

Observe all local and general rules regarding the handling, use and transportation of firearms.

2.10. ENSURE THAT YOU HAVE A DEEP UNDERSTANDING OF THE SAFETY FEATURES OF YOUR PISTOL.

Never rely on only the safety system to prevent the accidents itself. It is an obligation for you to make yourself familiar with and utilize the safety features of your gun; the best to prevent accidents is to follow the rules for safety and safe handling procedures defined in the product manual.

2.11. NEVER ALLOW A FIREARM TO BE USED BY INDIVIDUALS WHO DO NOT UNDERSTAND ITS SAFE OPERATION OR HAVE NOT READ THESE FIREARM SAFETY RULES.

2.12. NEVER LEAVE A FIREARM UNATTENDED. OTHERWISE, AN UNAUTHORIZED PERSON MAY POSE A THREAT FOR OTHER PERSONS AND CAUSE DAMAGES OR EVEN DEATH, WHERE ALL RESPONSIBILITY WILL BE YOURS.

2.13. FOR YOUR SAFETY AND THE SAFETY OF OTHERS, IT IS IMPERATIVE THAT YOU KEEP YOUR FIREARM ATE, COOL AND AIRED LOCATION AFTER IT IS SECURED.

2.14. NEVER ATTEMPT TO REMOVE A STUCK PROJECTILE IN THE BARREL BORE THROUGH FIRING ANOTHER ONE.

2.15. MAKE SURE YOU ARE DEEPLY FAMILIAR WITH THE OPERATION BEFORE USING AND LOADING A GUN.

2.16. ALLOW ONLY AUTHORIZED TECHNICAL SERVICES TO UNDERTAKE REPAIR PROCEDURES.

2.17. IT IS BOTH DANGEROUS AND FORBIDDEN TO MAKE MECHANICAL MODIFICATIONS ON THE PARTS OF THE FIREARM. PLEASE NOTE THAT ANY PRODUCTS TREATED THIS WAY WILL BE EXCLUDED FROM THE SCOPE OF THE WARRANTY.

2.18. USER OF THE FIREARM SHOULD STAND AT A RANGE OF AT LEAST 2 METERS FROM OTHER PERSONS.

2.19. AVOID SQUEEZING THE TRIGGER UNNECESARILY.

3. PRODUCT AND FEATURES IDENTIFICATION

3.1. SUPLIED COMPONENTS

The package supplied includes;

- 1 Pistol Case
- 1 Pistol
- 2 Magazines
- 1 Owner's Manual
- 1 Cleaning and Lubricating Kit



3.2. MAIN PRODUCT FEATURES

Sarsilmaz pistols are manufactured using the latest technology with the help of the experience we have gained in the manufacturing of modern small arms intended for marksmanship, police and the army. Our guns use a recoil-operated, self-loading mechanism with mechanical lock-up. Handling of your pistol is safe as it is equipped with the ultimate safety mechanisms including automatic firing pin lock, hammer lock, and safety. It offers precise detection of the target and firing thanks to the adjustable sights (may differ based on the model) and ergonomic grip enabling an easy aiming. Sarsilmaz pistols are available in a wide range of models including both double action/single action (DA/SA) and single action only (SAO).

*******Use life of our products are 10 (ten) years.**

3.3. BASIC PARTS



3.4. ADDITIONAL FEATURES

SARSILMAZ semi-automatic pistols are specially designed for use by military and police forces. It is preferred by military and police forces thanks to its extraordinary performance compared to competitors.

NOTE:

Features below may vary for different models.



Ambidexter
safety lever



Adjustable
front sight



Flame hider



Picatinny rail
for polymer models



Firing pin



Adjustable
rear sight



Indicator



Ambidexter
magazine release



Changeable
front sight



Compensator



Picatinny rail
for steel models



Ergonomic
trigger guard



Changeable
grip cover



Steel magazine

3.5. TECHNICAL DATA and FEATURES

MODEL	B6	B6C	B6C	B6C	B6C
CALIBER	9x19 mm	9x19 mm	9x17 mm	7.65 mm	.22 LR
MECHANISM	SA / DA	SA / DA	SA / DA	SA / DA	SA / DA
CAPACITY	15+1 / 17+1	13+1	14+1	15+1 / 17+1	10+1
BARREL LENGTH	4.5" - 116 mm	3.8" - 99 mm	3.8" 98 mm	3.8" - 98 mm	4.2" - 107 mm
OVERALL LENGTH	8.1" - 207 mm	7.4" - 190 mm	7.0" - 180 mm	7.0" - 180 mm	7.3" - 185 mm
OVERALL HEIGHT	5.5" - 140 mm	5.2" - 134 mm	5.0" - 128 mm	5.0" - 128 mm	5.0" - 128 mm
OVERALL WIDTH	1.1" - 28 mm	1.1" - 28 mm	1.1" - 28 mm	1.1" - 28 mm	1.1" - 28 mm
WEIGHT	28.2 oz - 800 gr	25.2 oz - 715 gr	26.1 oz - 740 gr	25.4 oz - 720 gr	20.5 oz - 580 gr
SPECIFICATIONS	Polymer Frame, Alloyed Forged Steel & Forged Stainless Steel Barrel and Slide Rear Sight Manual Safety, Firing Pin Block and Hummer Block	Polymer Frame, Alloyed Forged Steel & Forged Stainless Steel Barrel and Slide Rear Sight Manual Safety, Firing Pin Block and Hummer Block	Polymer Frame, Alloyed Forged Steel & Forged Stainless Steel Barrel and Slide Rear Sight Manual Safety, Firing Pin Block and Hummer Block	Polymer Frame, Alloyed Forged Steel & Forged Stainless Steel Barrel and Slide Rear Sight Manual Safety, Firing Pin Block and Hummer Block	Polymer Frame, Alloyed Forged Steel & Forged Stainless Steel Barrel and Slide Rear Sight Manual Safety, Firing Pin Block and Hummer Block

MODEL	CM9	CM9 GEN2	P8L	P8S	K2	K2-C
CALIBER	9x19 mm	9x19 mm	9x19 mm	9x19 mm	9x19 mm	9x19 mm
MECHANISM	SA / DA	SA / DA	SA / DA	SA / DA	SA / DA	SA / DA
CAPACITY	15+1 / 17+1	15+1 / 17+1	15+1 / 17+1	15+1 / 17+1	15+1 / 17+1	15+1 / 17+1
BARREL LENGTH	3.8" - 97 mm	3.8" - 97 mm	4.6" - 117 mm	3.8" - 97 mm	4.6" - 117 mm	3.8" - 97 mm
OVERALL LENGTH	7.3" - 187 mm	7.3" - 187 mm	8.0" - 204 mm	7.2" - 184 mm	8.0" - 204 mm	7.2" - 184 mm
OVERALL HEIGHT	5.6" - 142 mm	5.6" - 142 mm	5.5" - 140 mm	5.6" - 142 mm	5.5" - 140 mm	5.6" - 142 mm
OVERALL WIDTH	1.1" - 28 mm	1.1" - 28 mm	1.4" - 38 mm	1.4" - 38 mm	1.3" - 33 mm	1.3" - 33 mm
WEIGHT	28.5 oz - 810 gr	29 oz - 820 gr	37.9 oz - 1075 gr	35.8 oz - 1015 gr	35.8"oz - 1015 gr	33.5 oz - 950 gr
SPECIFICATIONS	Polymer Frame, Alloyed Forged Steel & Forged Stainless Steel Barrel and Slide Adjustable Rear Sight Manual Safety, Firing Pin Block and Hummer Block	Polymer Frame, Alloyed Forged Steel Barrel and Slide Adjustable Rear Sight Manual Safety, Firing Pin Block and Hummer Block	Alloyed Forged Steel & Forged Stainless Steel Frame, Barrel and Slide Adjustable Rear Sight Manual Safety, Firing Pin Block and Hummer Block	Alloyed Forged Steel & Forged Stainless Steel Frame, Barrel and Slide Adjustable Rear Sight Manual Safety, Firing Pin Block and Hummer Block	Alloyed Forged Steel & Forged Stainless Steel Frame, Barrel and Slide Rear Sight Decocker and Firing Pin Block Fully Ambidextrous	Alloyed Forged Steel & Forged Stainless Steel Frame, Barrel and Slide Adjustable Rear Sight Decocker and Firing Pin Block Fully Ambidextrous

MODEL	K2-45	K2-45C	K12	K12 SPORT	KILINÇ 2000 LIGHT	KILINÇ 2000 MEGA
CALIBER	.45 Auto	.45 Auto	9x19 mm	9x19 mm	9x19 mm	9x19 mm
MECHANISM	SA / DA	SA / DA	SA	SA	SA / DA	SA / DA
CAPACITY	14+1	13+1	15+1 / 17+1	15+1 / 17+1	15+1 / 17+1	15+1 / 17+1
BARREL LENGTH	4.7" - 120 mm	4.2" - 107 mm	5.1" - 131 mm	4.7" - 120 mm	4.5" - 116 mm	4.5" - 116 mm
OVERALL LENGTH	8.3" - 212 mm	7.8" - 200 mm	9.0" - 230 mm	8.5" - 218 mm	8.0" - 203 mm	8.0" - 204 mm
OVERALL HEIGHT	5.7" - 147 mm	5.7" - 147 mm	5.5" - 140 mm	5.9" - 150 mm	5.5" - 140 mm	5.5" - 140 mm
OVERALL WIDTH	1.3" - 35 mm	1.3" - 35 mm	1.3" - 35 mm	1.3" - 35 mm	1.4" - 38 mm	1.3" - 35 mm
WEIGHT	39.3 oz - 1115 gr	38 oz - 1080 gr	41.2 oz - 1170 gr	41.6 oz - 1180 gr	35.6 oz - 1010 gr	35.2 oz - 1000 gr
SPECIFICATIONS	Alloyed Forged Steel & Forged Stainless Steel Frame, Barrel and Slide Adjustable Rear Sight Manual Safety, Firing Pin Block and Hummer Block	Alloyed Forged Steel Frame, Barrel and Slide Adjustable Rear Sight Manual Safety, Firing Pin Block and Hummer Block	Alloyed Forged Steel & Forged Stainless Steel Frame, Barrel and Slide Adjustable Rear Sight Manual Safety, Firing Pin Block and Hummer Block	Alloyed Forged Steel & Forged Stainless Steel Frame, Barrel and Slide Adjustable Rear Sight Manual Safety, Firing Pin Block and Hummer Block	Alloyed Forged Steel & Forged Stainless Steel Frame, Barrel and Slide Rear Sight Manual Safety, Firing Pin Block and Hummer Block	Alloyed Forged Steel & Forged Stainless Steel Frame, Barrel and Slide Rear Sight Manual Safety and Firing Pin Block

4. PUTTING YOUR PRODUCT INTO SERVICE

4.1. PRELIMINARY PREPERATION

Handguns are generally protected with a thin layer of oil and it should be wiped from the bore using a clean swab or patch before using the firearm.

4.2. INSPECTING YOUR PISTOL

You can inspect your firearm to check it is unloaded through following the steps below:

- a. Grasp the pistol pointing it in a safe direction.
- b. Ensure your firearm is secured during the inspection. If not, set the manual safety to “locked position” until the red point becomes invisible. B6, B6C, CM9, CM9-GEN2, K2-45, K2-45 C, K12 ,K12 SPORT, P8S, P8L, LIGHT (**Figure 1**); MEGA, (**Figure 2**); K2, K2C (**Figure 3**)

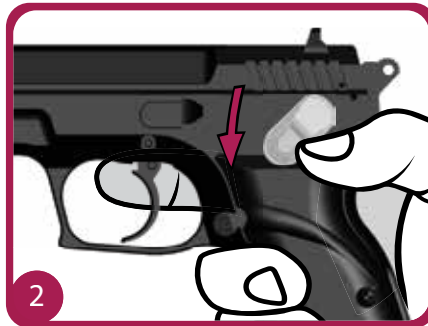

- c. Remove the magazine pressing the magazine release on the left hand side of the gun to check whether there are any cartridges in the magazine. **(Figure 4)**
- d. Set the manual safety in "firing position" until the red point becomes visible again. B6, B6C, CM9, CM9-GEN2, K2-45, K2-45 C, K12, K12 SPORT, P8S, P8L, LIGHT **(Figure 5)**; MEGA, **(Figure 6)**; K2, K2C **(Figure 7)**
- e. Slide back using the serrated sides on the slide. Check the chamber to see the gun is unloaded. **(Figure 8)**
- f. You can perform the same without sliding back for models equipped with a cartridge indicator. You can see the cartridge in the chamber when looked from the indicator. **(Figure 9)**

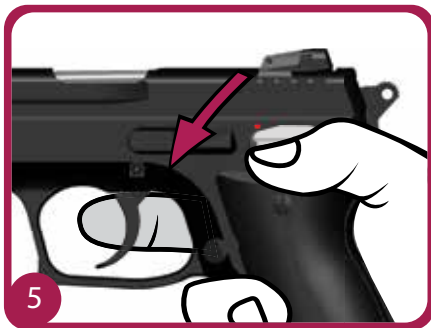
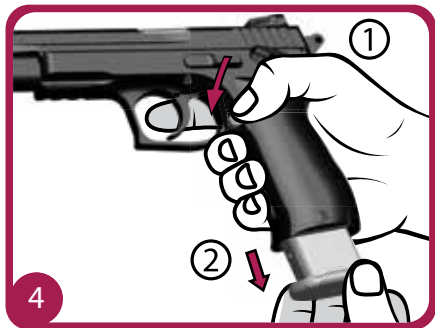

g. You can squeeze the trigger after pointing your pistol to a safe direction. It is not recommended to squeeze the trigger when unloaded (without ammunition in the barrel), so do not do this often. Accordingly, it is recommended that the adjusted hammer be dropped as described under 4.5.2.

4.3. AMMUNITION

- Use only original and high quality cartridges.
- Cartridges to be used must be compatible with your gun's caliber.
- Remember that the hand-loaded or other non-standard cartridges will be excluded from the scope of the warranty.

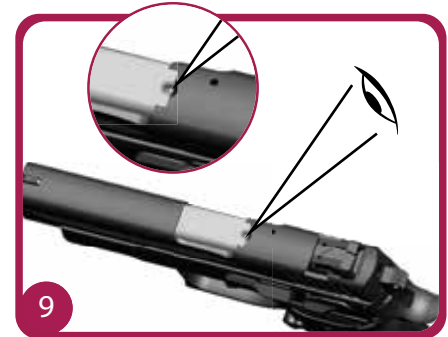
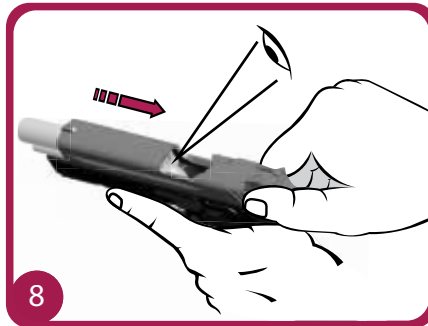

4.4. FIRING

4.4.1. CHECKS AND SAFETY BEFORE FIRING

- Always point your pistol to a safe direction.
- When you grasp the pistol keep your finger at the trigger guard instead of the trigger itself.
- Check the barrel to make sure there is no obstruction.
- When keeping your gun idle make sure that the slide is leaned backward.
- Oil should be wiped from the gun before loading, if appropriate.
- Never attempt to load or unload your pistol in cars, buildings or other similar narrow, closed areas (except for shooting ranges).
- Do not rely on safety systems. This cannot take the place of careful and wise handling of firearms.

4.4.2. LOADING YOUR MAGAZINE

- a. Grasp the magazine in forward position as you insert a cartridge downward on the magazine lips. **(Figure 10)**
- b. Slide the cartridge downwards until it reaches the rear wall of the magazine.
- c. Repeat the procedure for the number of cartridges you wish to load. You can check the number of cartridges inside from the holes on the magazine.

△ WARNING

Be careful to avoid any harm on the magazine lips when loading cartridges. Number of cartridges in the magazine can be identified from the holes on the side of the magazine. Do not attempt to load your magazine with more than the specified number of cartridges because doing so can cause damaged or crooked cartridges. Do not push them hard.

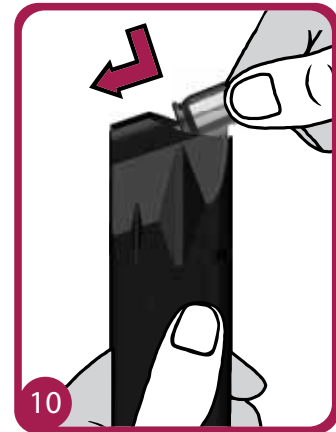

4.4.3. ASSEMBLING YOUR FIREARM

- a. Insert the loaded magazine into the magazine well of the pistol until it is locked in place. Wait for the click sound. (Magazine release will lock the magazine) Place the manual safety into "firing position". **(Figure 11)**
- b. Grasp the serrated sides of the slide from the rear and briskly pull the slide fully rearward. Do not attempt to catch the round by placing your hand over the ejection port. This will load the chamber and release the hammer. Place back the manual safety into "safe position". **(Figure 12)**

⚠ WARNING

Do not chamber a round until you are ready to fire. Do not attempt to block the round by placing your hand over the moving slide.

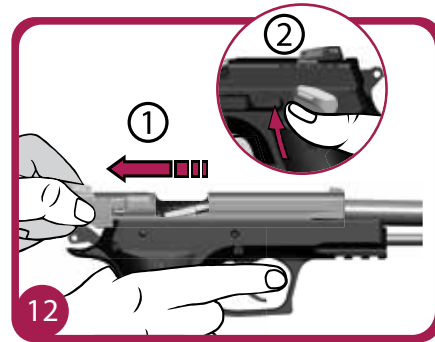
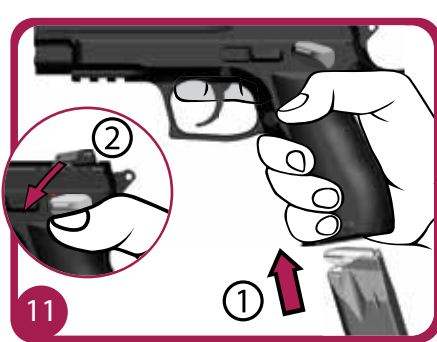

4.4.4. SETTING YOUR LINE OF FIRE

A line of fire can be set lining up the three dots. (Figure 13)

4.4.5. FIRING

- You can fire on target through applying the firing techniques.
- Grasp the trigger with your finger and pull it slowly.
- Keep your pistol directed to your target until you finish intended number of shots.
- When all your shots are fired, the slide will be locked rearwards by the barrel locking and NTA pin. Place your gun into “safe position”.
- Press magazine release to eject the magazine.
- Insert a loaded magazine in the firearm and press NTA pin or gently draw rearwards and release the slide to continue shooting. (Figure 14)
- Place the manual safety into “firing position” to continue shooting.

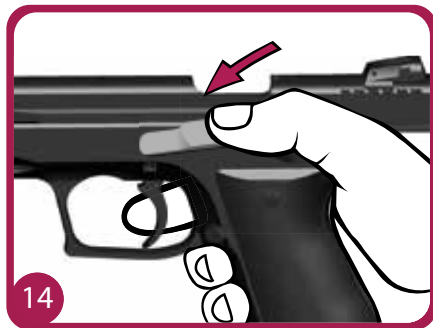

4.4.6. RELOADING YOUR PISTOL

Refer to "Loading Your Magazine" and "Assembling Your Firearm" to reload your pistol.

4.4.7. UNLOADING YOUR FIREARM

- a. Push the cartridge upwards using your thumb until it pops out of the magazine lip. (Figure 15)
- b. Repeat the same until the magazine is fully unloaded.

⚠ WARNING

You are responsible for the firearm at all times. Remember that your gun is loaded and ready fire until you are fully convinced that your gun is secured. You must always secure your firearm and ammunition separately after ensuring the gun is unloaded.

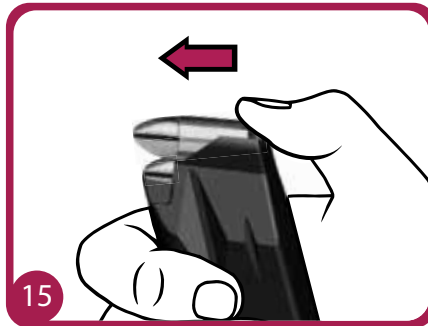

4.5. SECURING YOUR FIREARM

4.5.1. UNLOADING WHILE MAGAZINE AND BARREL ARE LOADED WITH CARTRIDGES

- The firearm is loaded with cartridges placed in the magazine.
- Point the muzzle to a safe direction.
- Press the magazine release to eject the magazine.
- For models B6, B6C, CM9, CM9-GEN2, K2-45, K2-45 C, K12, K12 SPORT, P8S, P8L, LIGHT, place the manual safety into "firing position". (Red point should be visible)
- For models MEGA, K2, K2C, place the manual safety into "safe position". (Red point should not be visible)
- Grasp the serrated sides of the slide to draw it rearward to eject the cartridge in the barrel. Loaded cartridge will be ejected by the extractor on the slide.

(Figure 16)

- Draw and release the slide fully for several times to see your pistol works smoothly without any jamming.
- Lock the firearm with the NTA pin when slide is drawn backwards.
- Check the barrel visually for cartridges.
- Press NTA pin to release the slide.
- Place the manual safety into "firing position". (Red point should be visible) and point your muzzle to a safe direction, dropping the hammer safely as described below.

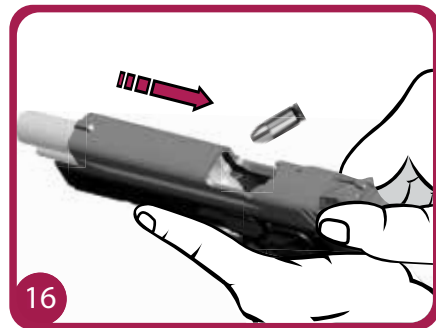

4.5.2. RELEASING YOUR HAMMER SAFELY

A. (B6, B6C, CM9, CM9-GEN2, K2-45, K2-45 C, K12, K12 SPORT, P8S, P8L, KILINÇ 2000 LIGHT, KILINÇ 2000 MEGA)

- Grip the adjusted hammer with the thumb of one hand while blocking the front side of the hammer with the thumb of the other hand. (Figure 17)
- Pull the trigger gently to release the hammer. Remove your thumb from the front side of the hammer to release the hammer slowly by using your thumb holding the hammer. (Figure 18)
- Release the trigger rearwards and place the manual safety into "safe position". (Figure 19)

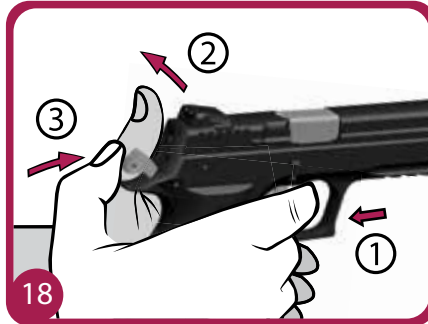
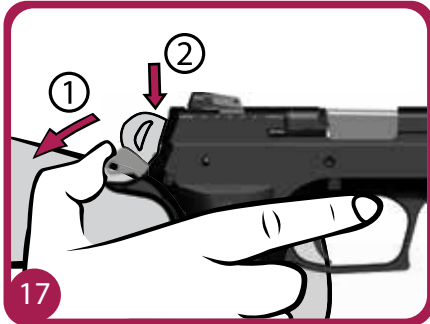

B. (K2 - K2C)

If you give up firing when the hammer is pulled backwards perform the following steps:

- a. Point your pistol to a safe direction and keep your finger away from the trigger. Place the manual safety down until the red point becomes invisible. **(Figure 20)**
- b. This will release the hammer and block the pin, allowing the trigger to be released.

⚠ WARNING

This system is only available in K2 and K2C models. **(De Cocker)**

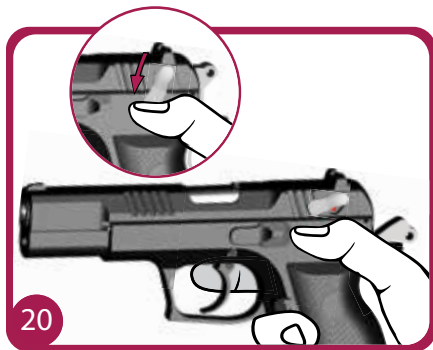

5. ADJUSTMENTS

5.1. ADJUSTMENT OF SIGHTS

- a. Models with adjustable rear sight can be adjusted to right-left or upwards-downwards. (Figure 21)
- b. For K12 model, you can adjust the rear sight to right-left or upwards-downwards. (Figure 22)
- c. Loosen the screw pin using a hex wrench to adjust front sight in K12 model. Fix
- d. the front sight by tightening the screw pin after adjusting it to right or left. (Figure 23)
- e. For models with fixed front sight, front sight may not be adjusted. (Figure 24)

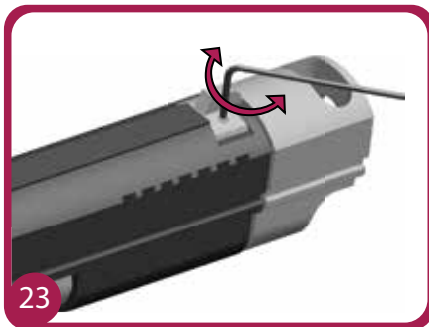
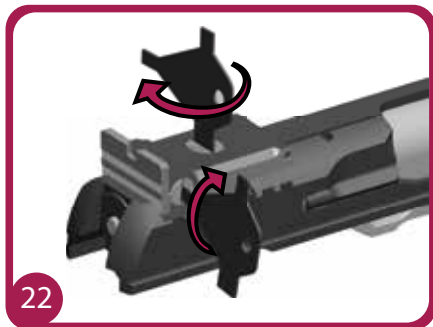
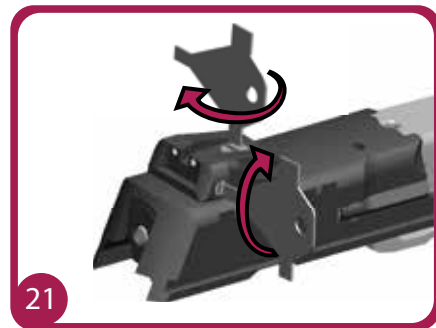

6. MAINTENANCE AND CLEANING

6.1. MAINTENANCE AND CLEANING KIT

The cleaning and maintenance kit supplied with your pistol includes:

- Bristle Brush
- Acrylic Fiber Brush
- Swab
- Protective Oil

6.2. DISASSEMBLING YOUR FIREARM

- Check your firearm again to see it is unloaded before disassembling.
- Press the magazine release to eject the magazine.
- Adjust the hammer manually. (Figure 25)
- Draw the slide backwards ensuring the two dots on the frame and slide are lined up. (Figure 26)

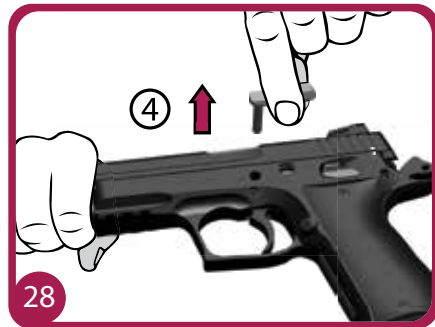
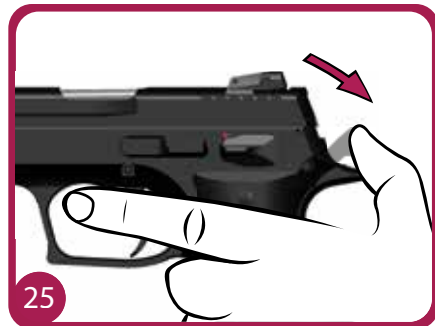
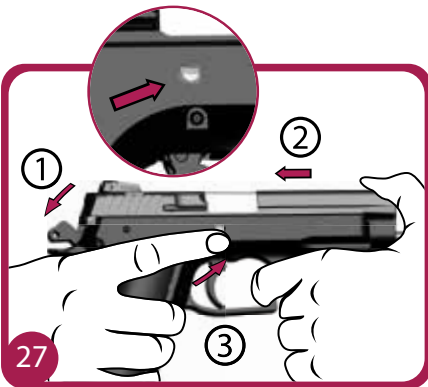
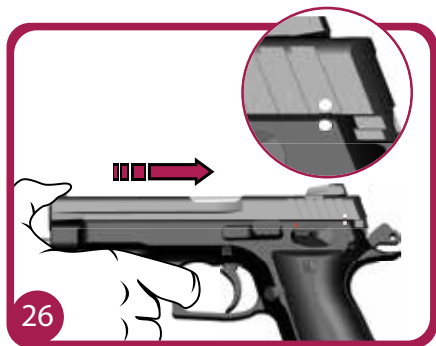

- e. NTA pin should be ejected from the back side manually or using a hard object when the pistol is in this position. (Figure 27-28)
- f. Pull the slide to the front slowly to remove. (Figure 29)
- g. Remove the recoil spring mechanism. (Figure 30)
- h. For K12 model, twist the flash suppressor to the direction of the arrow to remove it from the barrel. (Figure 31)
- i. Remove the barrel. (Figure 32)

⚠ WARNING

This completes field stripping of the firearm. No further disassembly should be attempted. Further disassembly should only be performed by relevantly specialized personnel.

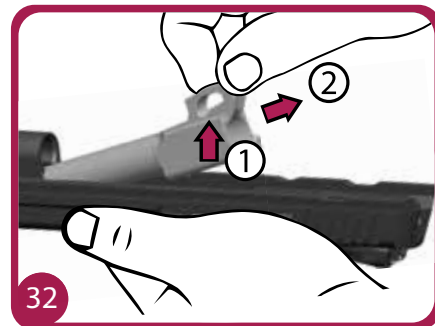
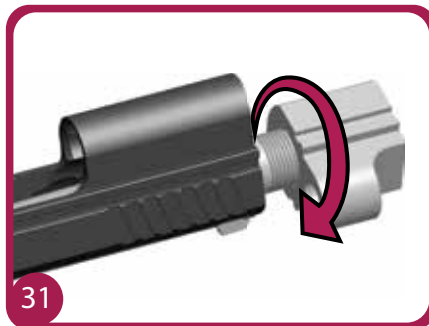
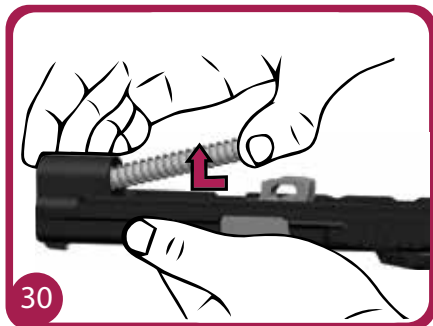
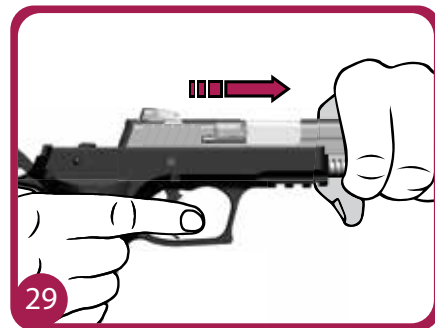

6.3. MAINTENANCE AND CLEANING OF YOUR FIREARM

It is crucial to have a good knowledge of the maintenance and handling of your firearm. Various experiences have shown that most of the operational failures in the firearm are due to the mistakes made during the maintenance. It is vital to give importance to the cleaning, lubrication and protection of your firearm. This determines whether your gun will operate smoothly when needed. For proper maintenance, the entire barrel should be treated. The process of cleaning and maintenance covers also the magazine.

- a. Check the firearm to see if it is unloaded when you grasp it.
- b. Wipe any heavy and sticky protective substances from the firearm during the first maintenance.
- c. Make sure all gunshot residue is wiped away. Clean any hard-to-reach areas using a small brush, swab and solvent.
- d. Clean the inside of the barrel and chamber thoroughly using a brush and acrylic fiber brush. Wipe the accumulated gunshot residue from the barrel. **(Figure 33-34)**
- e. Clean the inside of the barrel and the chamber first using a wet cloth and then with a dry cloth using a swap.
- f. Gently lubricate all moving parts of the firearm including the barrel, chamber, slide and slide rails on the frame, and the springs. Use a cloth to wipe the excess oil.

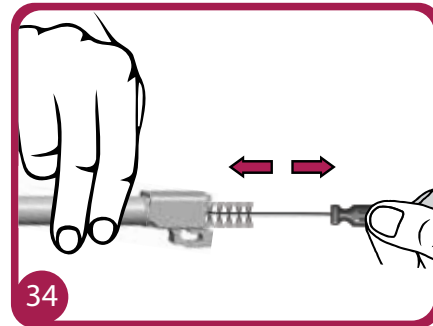
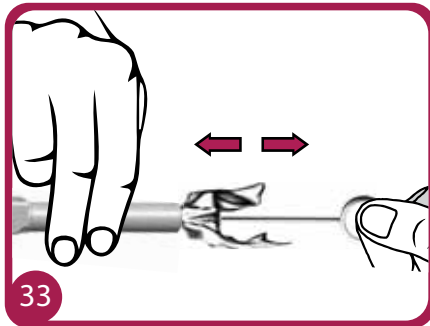

- g. Make sure the oil used is protective gun oil.
- h. Check all surfaces of the gun when cleaning. Check for any corrosion or peeling on the chrome coating.
- i. Make sure the firearm is operating smoothly.
- j. Avoid using corrosive or metal objects for cleaning.
- k. Perform a general cleaning of your gun after a series of shots. Clean the gunshot debris with a solvent.

6.4. REASSEMBLING OF YOUR FIREARM

- a. Check the barrel for any obstructions.
- b. Place the barrel inside the slide. **(Figure 35)**
- c. For K12 model, turn the flash suppressor it in the direction to place into the barrel and twist it until it reaches a straight position. **(Figure 36)**
- d. Place the reassembling string mechanism under the barrel. **(Figure 37)**

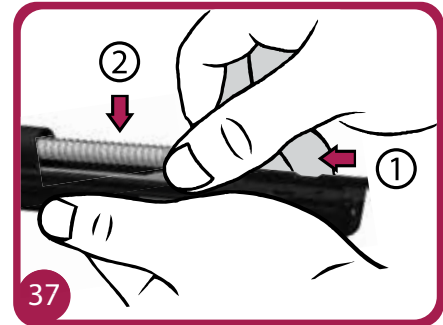
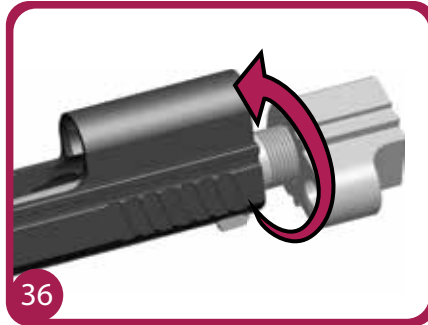
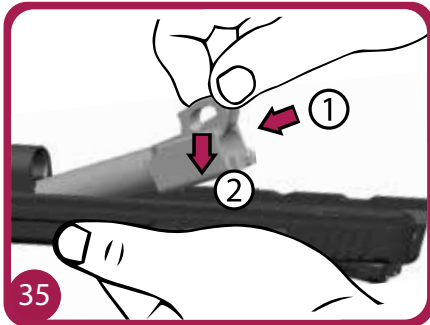

- e. Place the slide on the rails on the frame and pull the slide backwards until the dots on the frame and the slide are lined up. **(Figure 38)**
- f. Place the NTA pin to its original place. **(Figure 39)**
- g. Release the slide and drop the hammer in a safe way.

6.5. INSPECTION OF FUNCTIONS

- Cleaning and maintenance procedures are followed by the inspection of the functions.
- Remove the magazine to unload the gun.
- Pull back and release the slide several times.
- Check whether the slide falls into its place swiftly.
- Check the intensity of the recoil spring mechanism and see if the slide is moving easily.
- Pull the trigger to a safe direction to observe whether the hammer stretches backwards tightly and moves upward swiftly.
- Pull back and release the slide. This will also engage the hammer. Pull the trigger to observe if the hammer moves front swiftly.

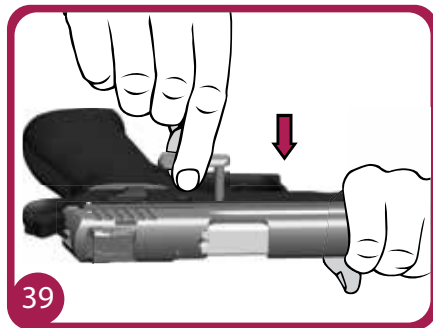
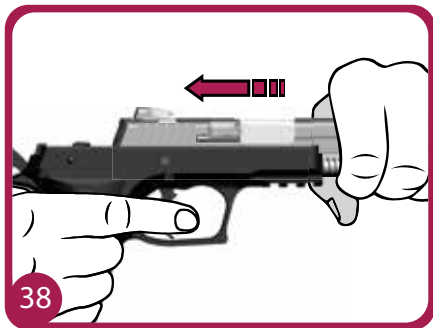

6.6. MAINTENANCE OF YOUR MAGAZINE

6.6.1. DISASSEMBLING YOUR MAGAZINE

- a. Make sure there is no cartridge in the magazine.
- b. Grasp the magazine upside down and push the magazine base lock by a tiny object. **(Figure 40)**
- c. Slide the magazine base lock over the grip to remove the half part of the magazine. **(Figure 41)**
- d. Remove the magazine base lock using one hand while applying pressure on the base
- e. lock with the other hand. **(Figure 42)**
- f. Disassemble the spring, the magazine follower and the base lock.

⚠ WARNING

Magazine spring may be released accidentally if the spring is not fixed during the assembly-disassembly since it will be under pressure.

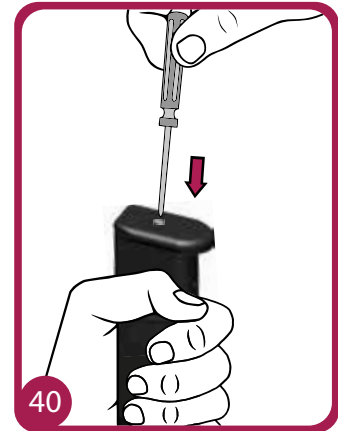

6.6.2. CLEANING YOUR MAGAZINE

- a. Clean the gunshot residue inside the magazine thoroughly using a bristle brush. Wipe the inside and outside of the magazine using an acrylic fiber brush and clean cloth. (Figure 43)
- b. Gently lubricate the inside of the magazine with an acrylic fiber brush. (Figure 44)

⚠ WARNING

Never attempt to clean the magazine using chemical solvents (gasoline, solvent mixed chemicals, etc.). Otherwise your product will be deemed

6.6.3. REASSEMBLING THE MAGAZINE

Repeat the disassembly steps in reverse order to reassembly your magazine.

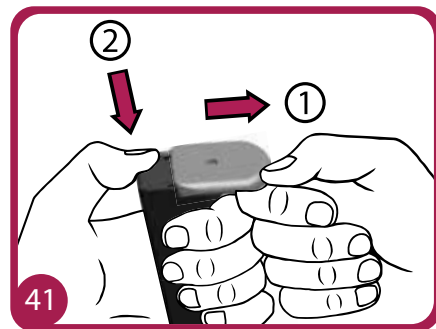
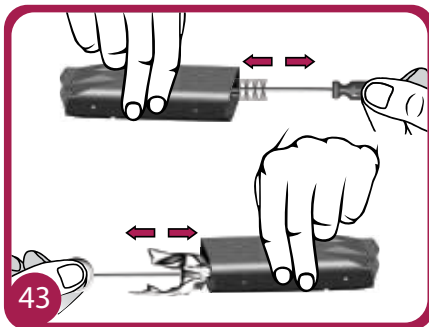
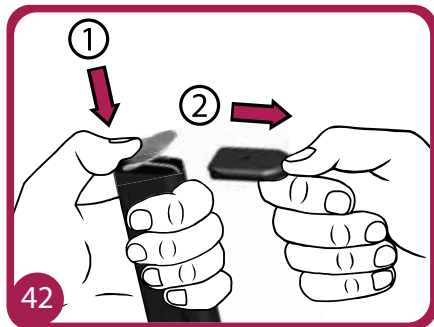

7. TROUBLESHOOTING

The majority of malfunctions experienced when firing the firearms will be the result of faulty maintenance or faulty ammunition.

The following table outlines the problems and their reasons as well as suggestions with respect to firing.		
PROBLEM	REASON	SOLUTION
Misfire	Check the manual safety	Place the manual safety in FIRING position.
	Firing pin problem	Have pistol examined by the authorized technical service.
	Dirty slide surface	Unload and clean the firearm
	Faulty cartridge	Remove the cartridge in the chamber, Feed a new cartridge into the barrel and continue firing.
Failure to feed the cartridge	Magazine stopped without reaching extreme forward position	Shove the magazine forward until you hear a click sound.
	Faulty magazine	Replace the magazine.
	Dirty magazine	Discharge all cartridges and clean the magazine.
	Faulty magazine assembly	Remove and insert the magazine again.
Cartridge case not ejected	Inefficient assembly	Pull the slide backwards and gently shake the extractor by turning it upside down and wait for the jammed cartridge to drop. Continue firing. Have it examined by the authorized technical service if the problem persists.
	Faulty ejector	Have it examined by the authorized technical service.
	Faulty extractor	Have it examined by the authorized technical service.

PROBLEM	REASON	SOLUTION
Non-advance of cartridge from magazine to chamber	Fouling or blockage of chamber .	Clean the chamber.
	A previously jammed cartridge case.	Remove the cartridge case in the chamber.
	Crooked, dirty or rusty cartridge..	Do not use the faulty cartridge. Continue firing using reliable and trouble-free cartridges.
Faulty ejection	Fouling or blockage of chamber.	Remove the magazine after securing the gun. Extract the empty case by pushing the swap inside the barrel. Clean the chamber and the barrel.
	Crooked, dirty or rusty cartridge.	Replace the cartridge.
Slide locks in incompletely	Insufficient lubrication of the moving parts.	Lubricate the firearm.
Failure to push forward the pulled back slide	No cartridges in the magazine.	Remove the magazine and continue firing with new cartridges.
	Fouling of the slide and frame channels.	Disassembly your firearm to clean the fouling and lubricate as required.

8. EXPLODED WIEVS and PART LISTS

8.1. B6 EXPLODED WIEV

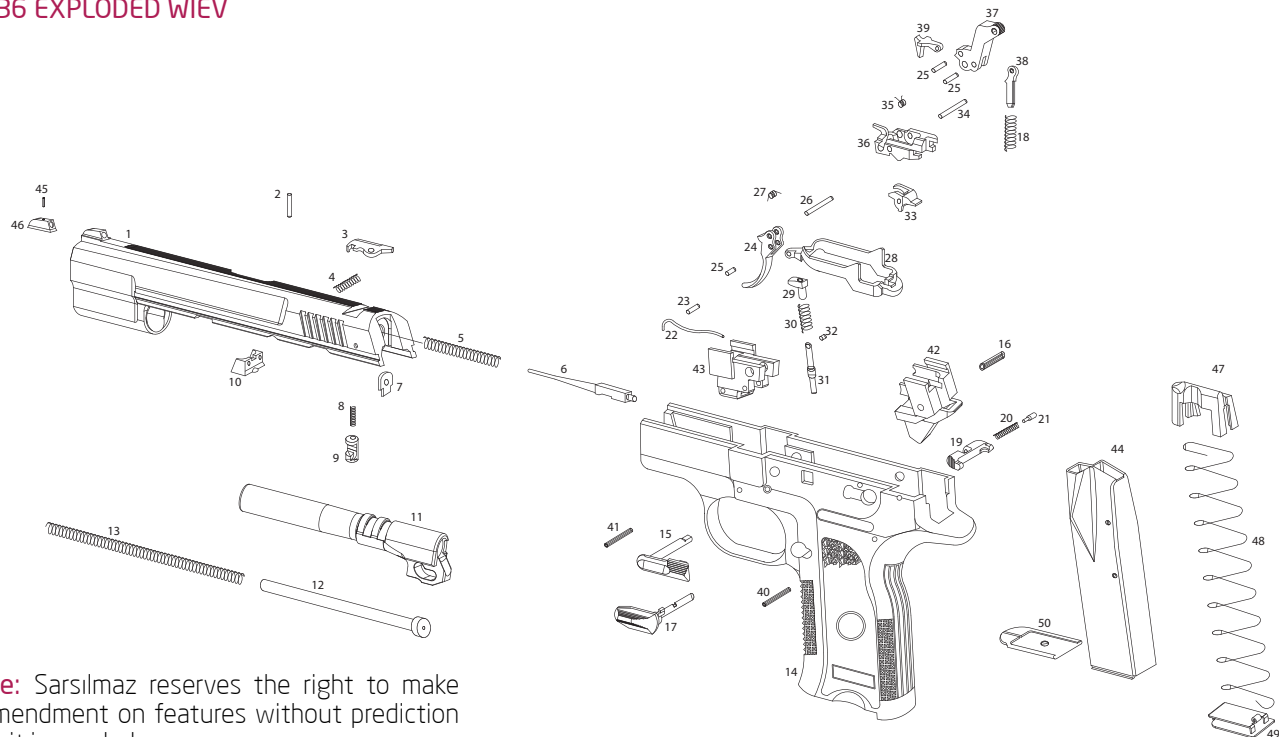

TNote: Sarsilmaz reserves the right to make an amendment on features without prediction when it is needed.

PART LIST

NUMBER	PART NAME	NUMBER	PART NAME
1	SLIDE	26	TRIGGER AXLE
2	EXTRACTOR PIN	27	TRIGGER REBOUND SPRING
3	EXTRACTOR	28	TRIGGER BAR
4	EXTRACTOR SPRING	29	TRIGGER BAR GUIDE
5	FIRING PIN SPRING	30	GUIDE SPRING
6	FIRING PIN	31	GUIDE PIN
7	FIRING PIN STOP	32	GUIDE SPRING LOCK PIN
8	FIRING PIN RETAINER SPRING	33	SEAR
9	FIRING PIN RETAINER	34	SEAR PIN
10	REAR SIGHT	35	SEAR SPRING
11	BARREL	36	SEAR HOUSING
12	RECOIL SPRING GUIDE	37	HAMMER
13	RECOIL SPRING	38	HAMMER STRUT
14	FRAME	39	HAMMER CLAMP
15	SLIDE RELEASE	40	REAR HOUSE PIN
16	HAMMER STRUT PIN	41	FRONT HOUSE PIN
17	SAFETY LEVER	42	REAR HOUSE
18	HAMMER SPRING	43	FRONT HOUSE
19	MAGAZINE RELEASE	44	MAGAZINE TUBE
20	MAGAZINE RELEASE SPRING	45	FRONT SIGHT PIN
21	MAGAZINE RELEASE PIN	46	FRONT SIGHT
22	SLIDE RELEASE SPRING	47	FOLLOWER
23	SPRING SUPPORT PIN	48	MAGAZINE SPRING
24	TRIGGER	49	MAGAZINE BUTTPLATE CATCH
25	TRIGGER&HAMMER PIN	50	MAGAZINE BUTTPLATE

8.2. B6C EXPLODED WIEV (9x19 mm - 9x17 mm - 7,65 mm - .22 LR)

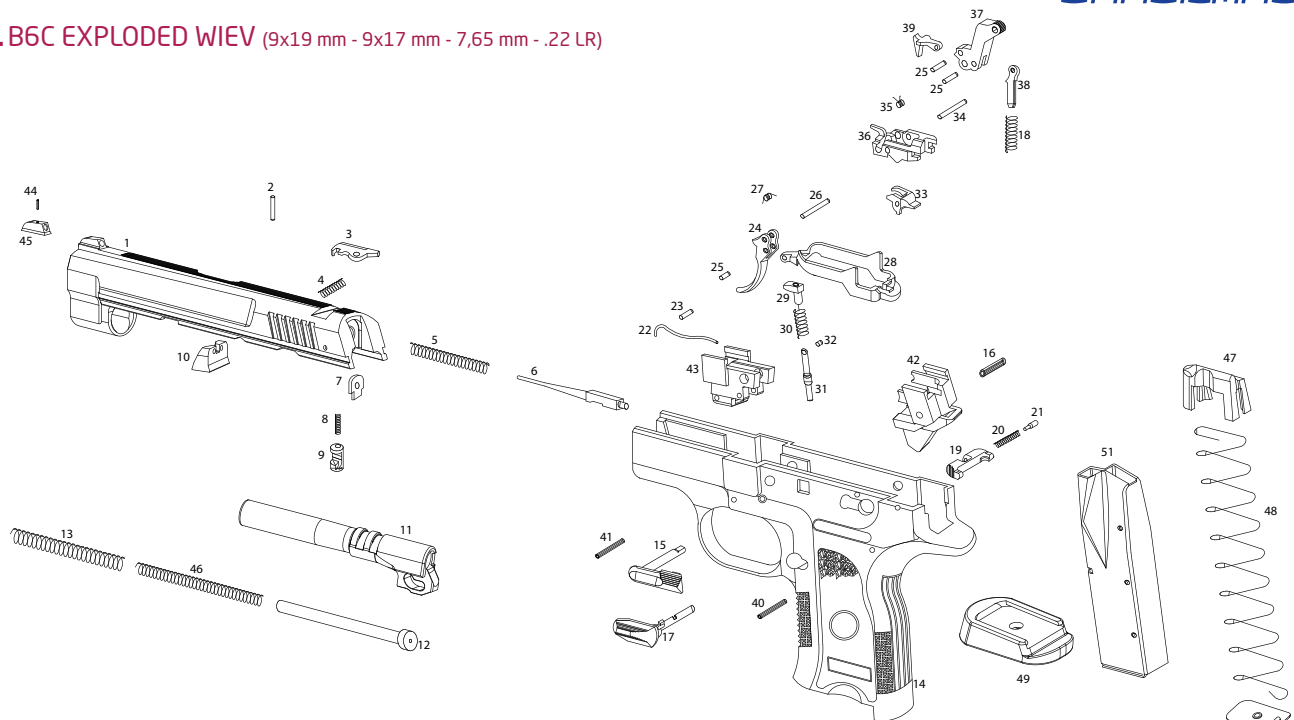

Note: Sarsılmaz reserves the right to make an amendment on features without prediction when it is needed. Pictures of parts may differ by caliber of the model.

PART LIST

NUMBER	PART NAME	NUMBER	PART NAME
1	SLIDE	27	TRIGGER REBOUND SPRING
2	EXTRACTOR PIN	28	TRIGGER BAR
3	EXTRACTOR	29	TRIGGER BAR GUIDE
4	EXTRACTOR SPRING	30	GUIDE SPRING
5	FIRING PIN SPRING	31	GUIDE PIN
6	FIRING PIN	32	GUIDE SPRING LOCK PIN
7	FIRING PIN STOP	33	SEAR
8	FIRING PIN RETAINER SPRING	34	SEAR PIN
9	FIRING PIN RETAINER	35	SEAR SPRING
10	REAR SIGHT	36	SEAR HOUSING
11	BARREL	37	HAMMER
12	RECOIL SPRING GUIDE	38	HAMMER STRUT
13	RECOIL SPRING 1	39	HAMMER CLAMP
14	FRAME	40	REAR HOUSE PIN
15	SLIDE RELEASE	41	FRONT HOUSE PIN
16	HAMMER STRUT PIN	42	REAR HOUSE
17	SAFETY LEVER	43	FRONT HOUSE
18	HAMMER SPRING	44	FRONT SIGHT PIN
19	MAGAZINE RELEASE	45	FRONT SIGHT
20	MAGAZINE RELEASE SPRING	46	RECOIL SPRING 2
21	MAGAZINE RELEASE PIN	47	FOLLOWER
22	SLIDE RELEASE SPRING	48	MAGAZINE SPRING
23	SPRING SUPPORT PIN	49	MAGAZINE BUTTPLATE
24	TRIGGER	50	MAGAZINE BUTTPLATE CATCH
25	TRIGGER&HAMMER PIN	51	MAGAZINE TUBE
26	TRIGGER AXLE		

8.3. CM9 EXPLODED VIEW

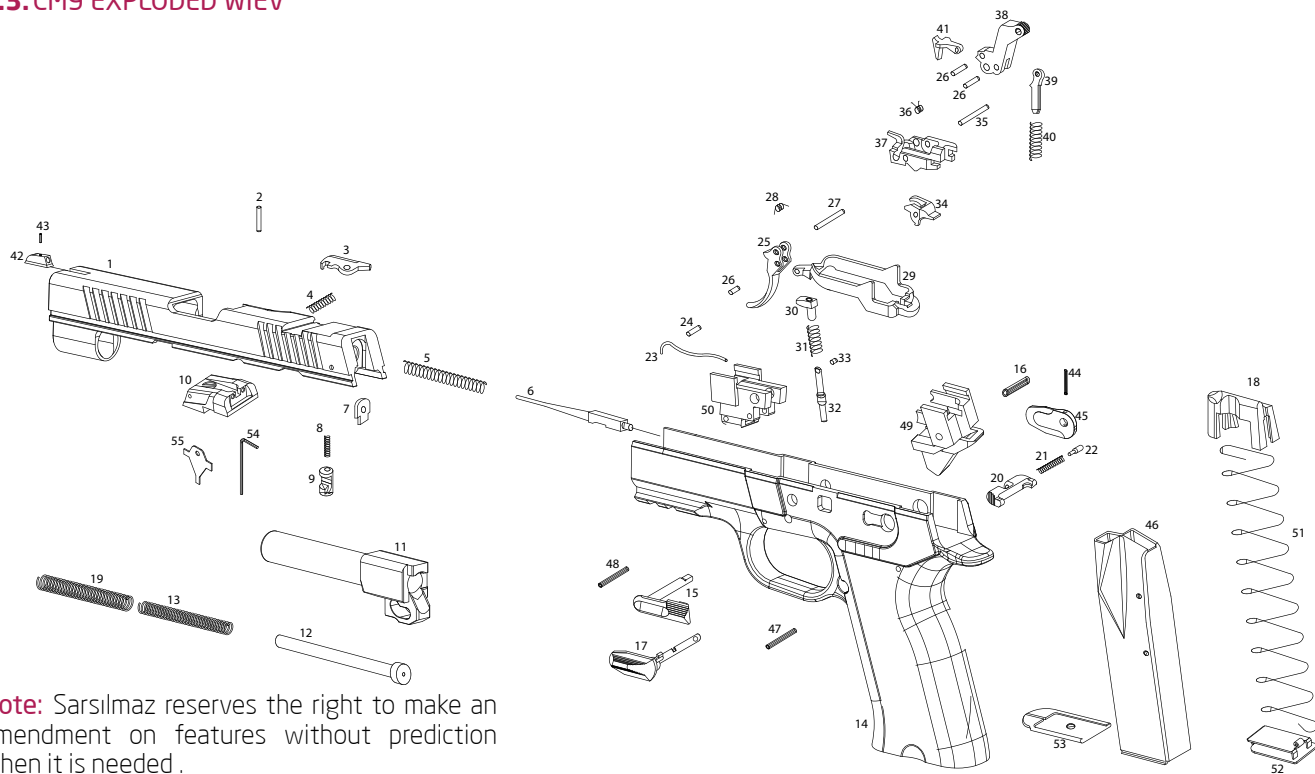

Note: Sarsılmaz reserves the right to make an amendment on features without prediction when it is needed.

PART LIST

NUMBER	PART NAME	NUMBER	PART NAME
1	SLIDE	29	TRIGGER BAR
2	EXTRACTOR PIN	30	TRIGGER BAR GUIDE
3	EXTRACTOR	31	GUIDE SPRING
4	EXTRACTOR SPRING	32	GUIDE PIN
5	FIRING PIN SPRING	33	GUIDE SPRING LOCK PIN
6	FIRING PIN	34	SEAR
7	FIRING PIN STOP	35	SEAR PIN
8	FIRING PIN RETAINER SPRING	36	SEAR SPRING
9	FIRING PIN RETAINER	37	SEAR HOUSING
10	ADJUSTABLE REAR SIGHT	38	HAMMER
11	BARREL	39	HAMMER STRUT
12	RECOIL SPRING GUIDE	40	HAMMER SPRING
13	RECOIL SPRING 2	41	HAMMER CLAMP
14	FRAME	42	FRONT SIGHT
15	SLIDE RELEASE	43	FRONT SIGHT PIN
16	HAMMER STRUT PIN	44	SAFETY LEVER CAP PIN
17	SAFETY LEVER	45	SAFETY LEVER CAP
18	FOLLOWER	46	MAGAZINE TUBE
19	RECOIL SPRING 1	47	REAR HOUSE PIN
20	MAGAZINE RELEASE	48	FRONT HOUSE PIN
21	MAGAZINE RELEASE SPRING	49	REAR HOUSE
22	MAGAZINE RELEASE PIN	50	FRONT HOUSE
23	SLIDE RELEASE SPRING	51	MAGAZINE SPRING
24	SPRING SUPPORT PIN	52	MAGAZINE BUTTPLATE CATCH
25	TRIGGER	53	MAGAZINE BUTTPLATE
26	TRIGGER&HAMMER PIN	54	ALLEN KEY
27	TRIGGER AXLE	55	ADJUSTABLE REAR SIGHT KEY
28	TRIGGER REBOUND SPRING		

PART LIST

NUMBER	PART NAME	NUMBER	PART NAME
1	SLIDE	31	GUIDE SPRING
2	EXTRACTOR PIN	32	GUIDE PIN
3	EXTRACTOR	33	GUIDE SPRING LOCK PIN
4	EXTRACTOR SPRING	34	SEAR
5	FIRING SPRING	35	SEAR PIN
6	FIRING PIN	36	SEAR SPRING
7	FIRING CATCH	37	EJECTOR
8	FIRING PIN BLOCK SPRING	38	HAMMER
9	FIRING PIN RETAINER	39	HAMMER STRUT
10	ADJUSTABLE REAR SIGHT	40	HAMMER SPRING
11	BARREL	41	HAMMER CLAMP
12	RECOIL SPRING GUIDE	42	FRONT SIGHT
13	RECOIL SPRING 2	43	FRONT SIGHT PIN
14	FRAME	44	SAFETY LEVER CAP PIN
15	SLIDE RELEASE	45	SAFETY LEVER CAP
16	HAMMER STRUT PIN	46	MAGAZINE TUBE
17	SAFETY LEVER	47	REAR HOUSE PIN
18	FOLLOWER	48	FRONT HOUSE PIN
19	RECOIL SPRING 1	49	REAR HOUSE
20	MAGAZINE RELEASE	50	FRONT HOUSE
21	MAGAZINE RELEASE SPRING	51	MAGAZINE SPRING
22	MAGAZINE RELEASE PIN	52	MAGAZINE INSERT
23	SLIDE RELEASE SPRING	53	MAGAZINE FLOOR PLATE
24	SPRING SUPPORT PIN	54	ALLEN KEY
25	TRIGGER	55	ADJUSTABLE REAR SIGHT KEY
26	TRIGGER&HAMMER PIN	56	BACK STRAP PIN
27	TRIGGER AXLE	57	BACK STRAP SMALL
28	TRIGGER SPRING	58	BACK STRAP MEDIUM
29	TRIGGER BAR	59	BACK STRAP LARGE
30	TRIGGER BAR GUIDE		

8.5. P8L EXPLODED VIEW

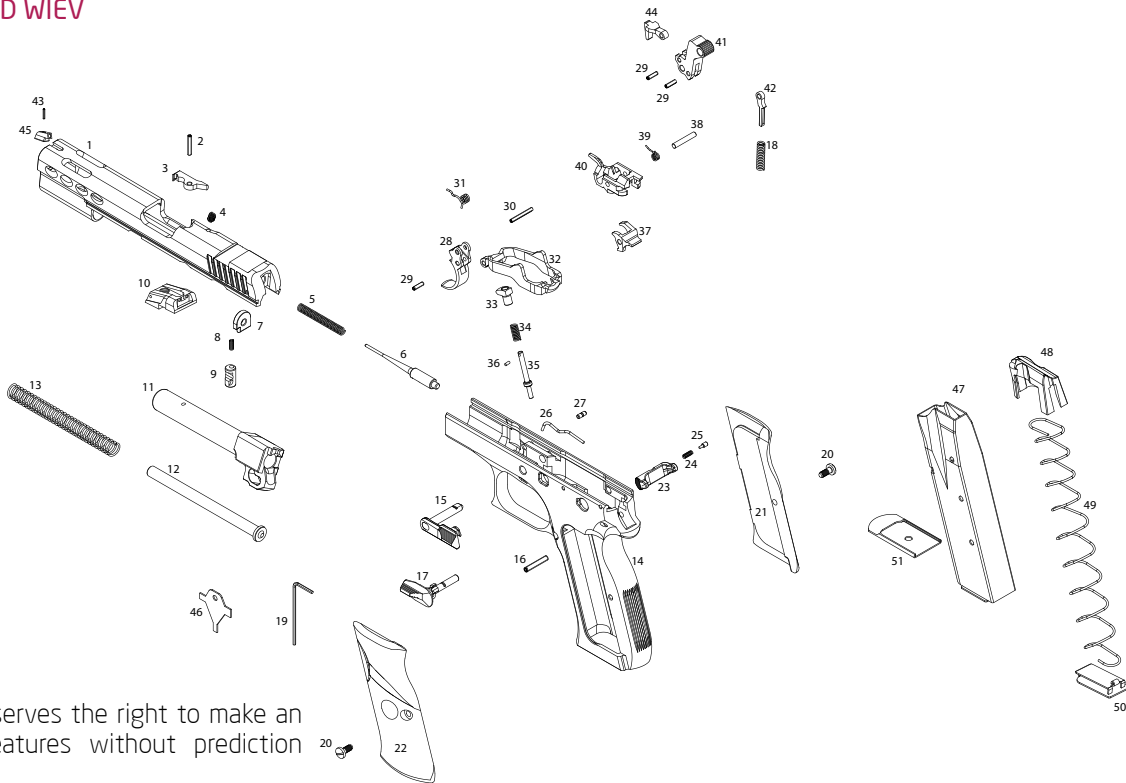

Note: Sarsılmaz reserves the right to make an amendment on features without prediction when it is needed.

PART LIST

NUMBER	PART NAME	NUMBER	PART NAME
1	SLIDE	27	SPRING SUPPORT PIN
2	EXTRACTOR PIN	28	TRIGGER
3	EXTRACTOR	29	TRIGGER&HAMMER PIN
4	EXTRACTOR SPRING	30	TRIGGER AXLE
5	FIRING PIN SPRING	31	TRIGGER REBOUND SPRING
6	FIRING PIN	32	TRIGGER BAR
7	FIRING PIN STOP	33	TRIGGER BAR GUIDE
8	FIRING PIN RETAINER SPRING	34	GUIDE SPRING
9	FIRING PIN RETAINER	35	GUIDE PIN
10	ADJUSTABLE REAR SIGHT	36	GUIDE SPRING LOCK PIN
11	BARREL	37	SEAR
12	RECOIL SPRING GUIDE	38	SEAR PIN
13	RECOIL SPRING	39	SEAR SPRING
14	FRAME	40	SEAR HOUSING
15	SLIDE RELEASE	41	HAMMER
16	HAMMER STRUT PIN	42	HAMMER STRUT
17	SAFETY LEVER	43	FRONT SIGHT PIN
18	HAMMER SPRING	44	HAMMER CLAMP
19	ALLEN KEY	45	FRONT SIGHT
20	GRIP SCREW	46	ADJUSTABLE REAR SIGHT KEY
21	GRIP-R	47	MAGAZINE TUBE
22	GRIP-L	48	FOLLOWER
23	MAGAZINE RELEASE	49	MAGAZINE SPRING
24	MAGAZINE RELEASE SPRING	50	MAGAZINE BUTTPLATE CATCH
25	MAGAZINE RELEASE PIN	51	MAGAZINE BUTTPLATE
26	SLIDE RELEASE SPRING		

8.6. P8S EXPLODED VIEW

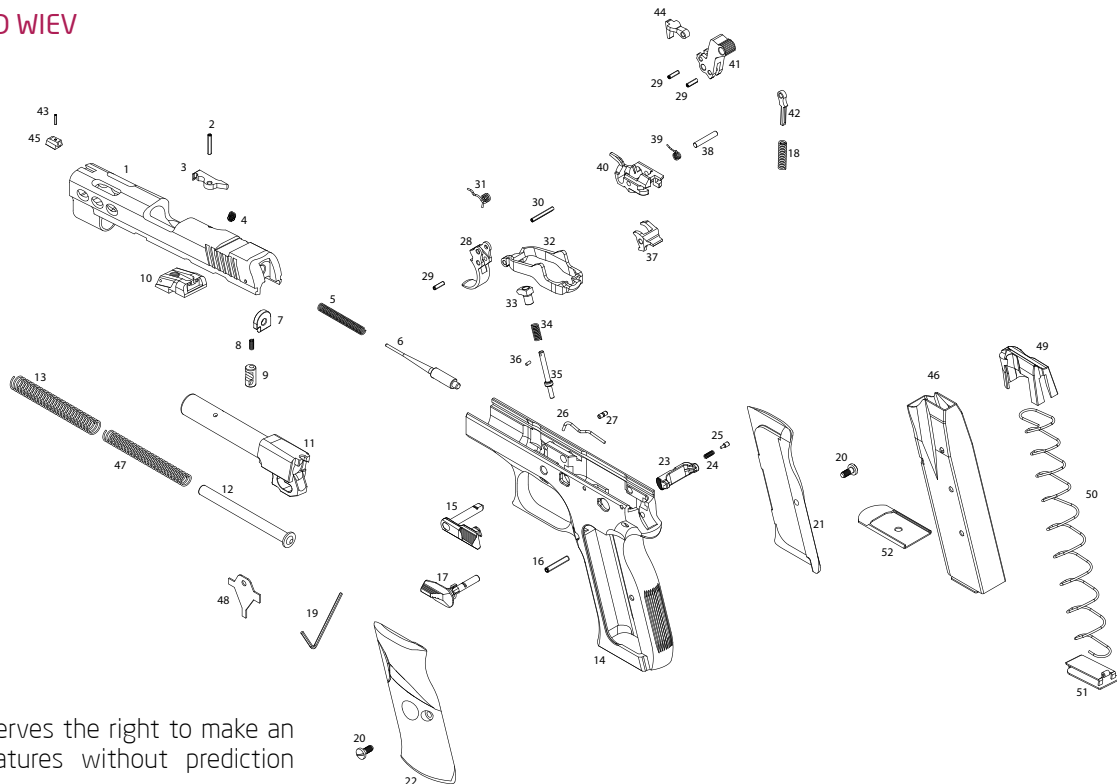

Note: Sarsılmaz reserves the right to make an amendment on features without prediction when it is needed.

PART LIST

NUMBER	PART NAME	NUMBER	PART NAME
1	SLIDE	27	SPRING SUPPORT PIN
2	EXTRACTOR PIN	28	TRIGGER
3	EXTRACTOR	29	TRIGGER&HAMMER PIN
4	EXTRACTOR SPRING	30	TRIGGER AXLE
5	FIRING PIN SPRING	31	TRIGGER REBOUND SPRING
6	FIRING PIN	32	TRIGGER BAR
7	FIRING PIN STOP	33	TRIGGER BAR GUIDE
8	FIRING PIN RETAINER SPRING	34	GUIDE SPRING
9	FIRING PIN RETAINER	35	GUIDE PIN
10	ADJUSTABLE REAR SIGHT	36	GUIDE SPRING LOCK PIN
11	BARREL	37	SEAR
12	RECOIL SPRING GUIDE	38	SEAR PIN
13	RECOIL SPRING 1	39	SEAR SPRING
14	FRAME	40	SEAR HOUSING
15	SLIDE RELEASE	41	HAMMER
16	HAMMER STRUT PIN	42	HAMMER STRUT
17	SAFETY LEVER	43	FRONT SIGHT PIN
18	HAMMER SPRING	44	HAMMER CLAMP
19	ALLEN KEY	45	FRONT SIGHT
20	GRIP SCREW	46	MAGAZINE TUBE
21	GRIP-R	47	RECOIL SPRING 2
22	GRIP-L	48	ADJUSTABLE REAR SIGHT KEY
23	MAGAZINE RELEASE	49	FOLLOWER
24	MAGAZINE RELEASE SPRING	50	MAGAZINE SPRING
25	MAGAZINE RELEASE PIN	51	MAGAZINE BUTTPLATE CATCH
26	SLIDE RELEASE SPRING	52	MAGAZINE BUTTPLATE

8.7.K2 EXPLODED WIEW

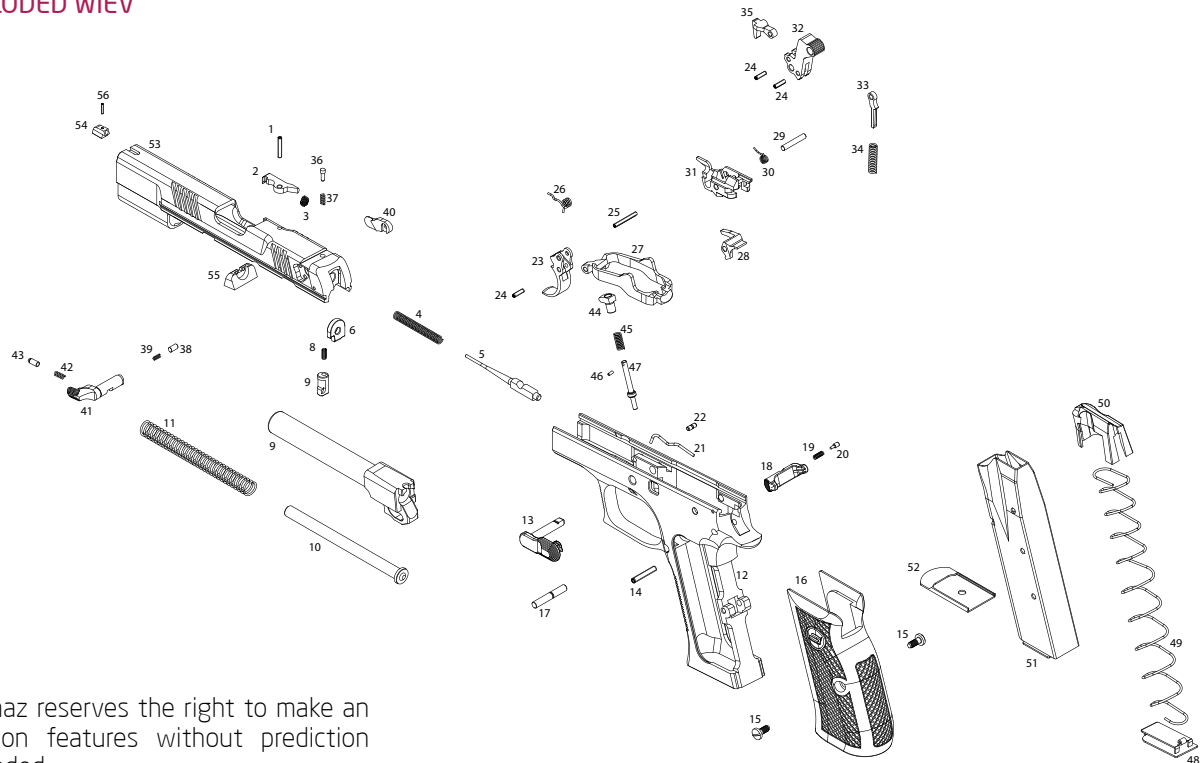

Note: Sarsılmaz reserves the right to make an amendment on features without prediction when it is needed.

PART LIST

NUMBER	PART NAME	NUMBER	PART NAME
1	EXTRACTOR PIN	29	SEAR PIN
2	EXTRACTOR	30	SEAR SPRING
3	EXTRACTOR SPRING	31	SEAR HOUSING
4	FIRING PIN SPRING	32	HAMMER
5	FIRING PIN	33	HAMMER STRUT
6	FIRING PIN STOP	34	HAMMER SPRING
7	FIRING PIN RETAINER SPRING	35	HAMMER CLAMP
8	FIRING PIN RETAINER	36	SAFETY PULSE PIN
9	BARREL	37	SAFETY PULSE PIN SPRING
10	RECOIL SPRING GUIDE	38	SAFETY BUTTON PIN
11	RECOIL SPRING	39	SAFETY BUTTON SPRING
12	FRAME	40	SAFETY LEVER CAP
13	SLIDE RELEASE	41	SAFETY LEVER
14	HAMMER STRUT PIN	42	SAFETY PIN SPRING
15	GRIP SCREW	43	SAFETY PIN
16	GRIP	44	TRIGGER BAR GUIDE
17	EJECTOR BLACK FIXED PIN	45	GUIDE SPRING
18	MAGAZINE RELEASE	46	GUIDE SPRING LOCK PIN
19	MAGAZINE RELEASE SPRING	47	GUIDE PIN
20	MAGAZINE RELEASE PIN	48	MAGAZINE BUTTPLATE CATCH
21	SLIDE RELEASE SPRING	49	MAGAZINE SPRING
22	SPRING SUPPORT PIN	50	FOLLOWER
23	TRIGGER	51	MAGAZINE TUBE
24	TRIGGER&HAMMER PIN	52	MAGAZINE BUTTPLATE
25	TRIGGER AXLE	53	SLIDE
26	TRIGGER REBOUND SPRING	54	FRONT SIGHT
27	TRIGGER BAR	55	REAR SIGHT
28	SEAR	56	FRONT SIGHT PIN

PART LIST

NUMBER	PART NAME	NUMBER	PART NAME
1	EXTRACTOR PIN	31	SEAR HOUSING
2	EXTRACTOR	32	HAMMER
3	EXTRACTOR SPRING	33	HAMMER STRUT
4	FIRING PIN SPRING	34	HAMMER SPRING
5	FIRING PIN	35	HAMMER CLAMP
6	FIRING PIN STOP	36	SAFETY PULSE PIN
7	FIRING PIN RETAINER SPRING	37	SAFETY PULSE PIN SPRING
8	FIRING PIN RETAINER	38	SAFETY BUTTON PIN
9	BARREL	39	SAFETY BUTTON SPRING
10	RECOIL SPRING GUIDE	40	SAFETY LEVER CAP
11	RECOIL SPRING 1	41	SAFETY LEVER
12	FRAME	42	SAFETY PIN SPRING
13	SLIDE RELEASE	43	SAFETY PIN
14	HAMMER STRUT PIN	44	RECOIL SPRING 2
15	GRIP SCREW	45	TRIGGER BAR GUIDE
16	GRIP	46	GUIDE SPRING
17	EJECTOR BLACK FIXED PIN	47	GUIDE SPRING LOCK PIN
18	MAGAZINE RELEASE	48	GUIDE PIN
19	MAGAZINE RELEASE SPRING	49	MAGAZINE BUTTPLATE CATCH
20	MAGAZINE RELEASE PIN	50	MAGAZINE SPRING
21	SLIDE RELEASE SPRING	51	FOLLOWER
22	SPRING SUPPORT PIN	52	MAGAZINE TUBE
23	TRIGGER	53	MAGAZINE BUTTPLATE
24	TRIGGER&HAMMER PIN	54	SLIDE
25	TRIGGER AXLE	55	FRONT SIGHT
26	TRIGGER REBOUND SPRING	56	ADJUSTABLE REAR SIGHT
27	TRIGGER BAR	57	FRONT SIGHT PIN
28	SEAR	58	ALLEN KEY
29	SEAR PIN	59	ADJUSTABLE REAR SIGHT KEY
30	SEAR SPRING		

8.9.K2-45 EXPLODED VIEW

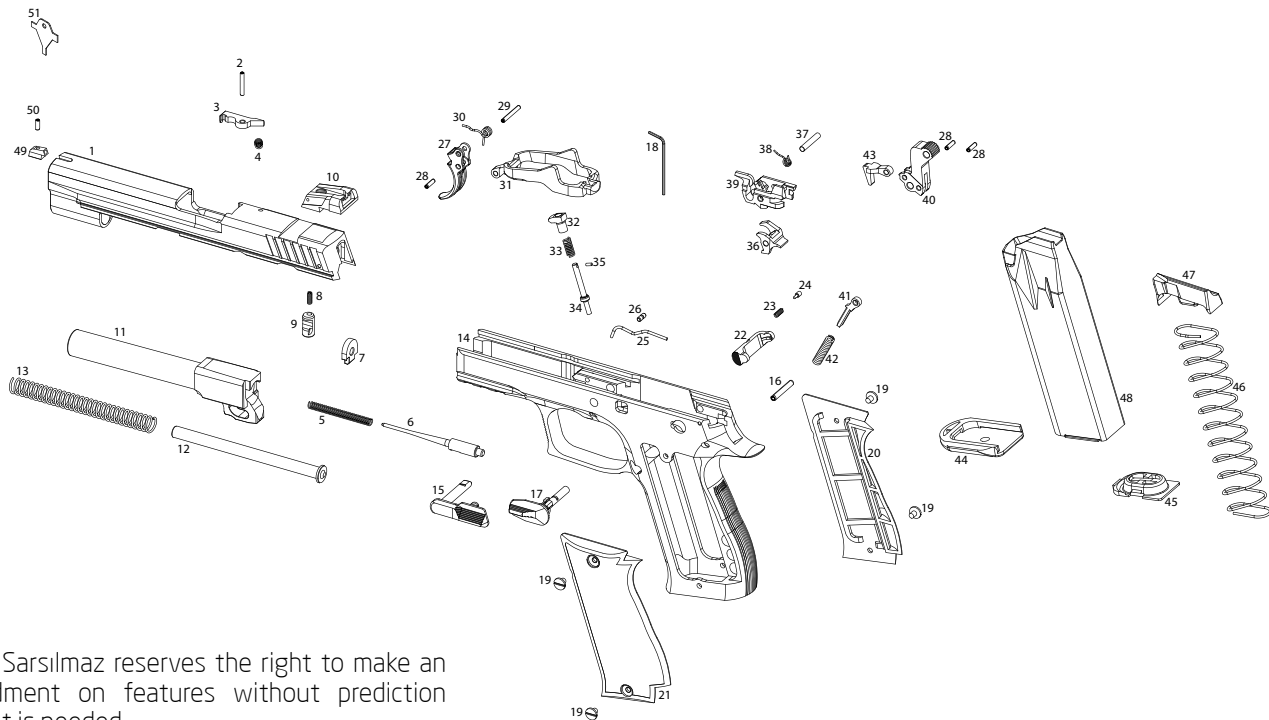

Note: Sarsılmaz reserves the right to make an amendment on features without prediction when it is needed.

PART LIST

NUMBER	PART NAME	NUMBER	PART NAME
1	SLIDE	27	TRIGGER
2	EXTRACTOR PIN	28	TRIGGER&HAMMER PIN
3	EXTRACTOR	29	TRIGGER AXLE
4	EXTRACTOR SPRING	30	TRIGGER REBOUND SPRING
5	FIRING PIN SPRING	31	TRIGGER BAR
6	FIRING PIN	32	TRIGGER BAR GUIDE
7	FIRING PIN STOP	33	GUIDE SPRING
8	FIRING PIN RETAINER SPRING	34	GUIDE PIN
9	FIRING PIN RETAINER	35	GUIDE SPRING LOCK PIN
10	ADJUSTABLE REAR SIGHT	36	SEAR
11	BARREL	37	SEAR PIN
12	RECOIL SPRING GUIDE	38	SEAR SPRING
13	RECOIL SPRING	39	SEAR HOUSING
14	FRAME	40	HAMMER
15	SLIDE RELEASE	41	HAMMER STRUT
16	HAMMER STRUT PIN	42	HAMMER SPRING
17	SAFETY LEVER	43	HAMMER CLAMP
18	ALLEN KEY	44	MAGAZINE BUTTPLATE
19	GRIP SCREW	45	MAGAZINE BUTTPLATE CATCH
20	GRIP-R	46	MAGAZINE SPRING
21	GRIP-L	47	FOLLOWER
22	MAGAZINE RELEASE	48	MAGAZINE TUBE
23	MAGAZINE RELEASE SPRING	49	FRONT SIGHT
24	MAGAZINE RELEASE PIN	50	FRONT SIGHT PIN
25	SLIDE RELEASE SPRING	51	ADJUSTABLE REAR SIGHT KEY
26	SPRING SUPPORT PIN		

8.10.K2-45 C EXPLODED WIEV

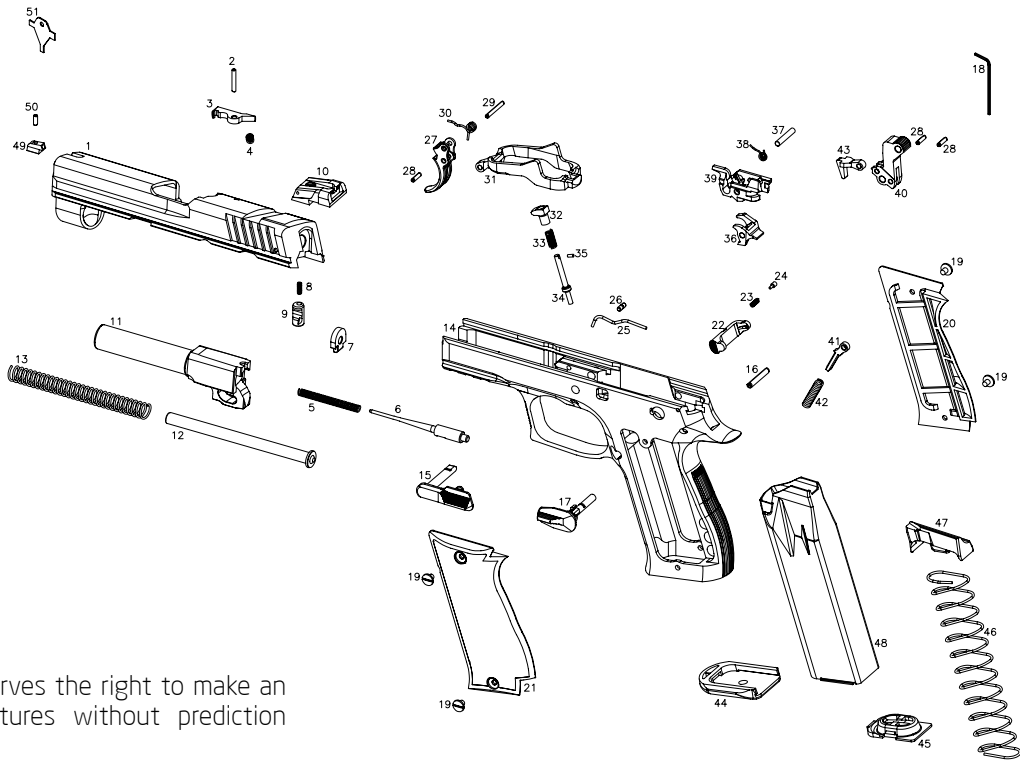

Note: Sarsılmaz reserves the right to make an amendment on features without prediction when it is needed.

PART LIST

NUMBER	PART NAME	NUMBER	PART NAME
1	SLIDE	27	TRIGGER
2	EXTRACTOR PIN	28	TRIGGER&HAMMER PIN
3	EXTRACTOR	29	TRIGGER AXLE
4	EXTRACTOR SPRING	30	TRIGGER SPRING
5	FIRING SPRING	31	TRIGGER BAR
6	FIRING PIN	32	TRIGGER BAR GUIDE
7	FIRING CATCH	33	GUIDE SPRING
8	FIRING PIN BLOCK SPRING	34	GUIDE PIN
9	FIRING PIN RETAINER	35	GUIDE SPRING LOCK PIN
10	ADJUSTABLE REAR SIGHT	36	SEAR
11	BARREL	37	SEAR PIN
12	RECOIL SPRING GUIDE	38	SEAR SPRING
13	RECOIL SPRING	39	EJECTOR
14	FRAME	40	HAMMER
15	SLIDE RELEASE	41	HAMMER STRUT
16	HAMMER STRUT PIN	42	HAMMER SPRING
17	SAFETY LEVER	43	HAMMER CLAMP
18	ALLEN KEY	44	MAGAZINE FLOOR PLATE
19	GRIP SCREW	45	MAGAZINE INSERT
20	RIGHT GRIP	46	MAGAZINE SPRING
21	LEFT GRIP	47	FOLLOWER
22	MAGAZINE RELEASE	48	MAGAZINE TUBE
23	MAGAZINE RELEASE SPRING	49	FRONT SIGHT
24	MAGAZINE RELEASE PIN	50	FRONT SIGHT PIN
25	SLIDE RELEASE SPRING	51	ADJUSTABLE REAR SIGHT KEY
26	SPRING SUPPORT PIN		

PART LIST

NUMBER	PART NAME	NUMBER	PART NAME
1	SLIDE	27	TRIGGER&HAMMER PIN
2	EXTRACTOR PIN	28	TRIGGER AXLE
3	EXTRACTOR	29	TRIGGER REBOUND SPRING
4	EXTRACTOR SPRING	30	TRIGGER BAR
5	FIRING PIN SPRING	31	TRIGGER BAR GUIDE
6	FIRING PIN	32	GUIDE SPRING
7	FIRING PIN STOP	33	GUIDE PIN
8	FIRING PIN RETAINER SPRING	34	GUIDE SPRING LOCK PIN
9	FIRING PIN RETAINER	35	SEAR
10	BARREL	36	SEAR PIN
11	RECOIL SPRING GUIDE	37	SEAR SPRING
12	RECOIL SPRING	38	SEAR HOUSING
13	FRAME	39	HAMMER
14	SLIDE RELEASE	40	HAMMER STRUT
15	HAMMER STRUT PIN	41	HAMMER SPRING
16	SAFETY LEVER	42	MAGAZINE BUTTPLATE
17	FLASH HIDER	43	MAGAZINE BUTTPLATE CATCH
18	ALLEN KEY	44	MAGAZINE SPRING
19	GRIP SCREW	45	FOLLOWER
20	GRIP-R	46	MAGAZINE TUBE
21	GRIP-L	47	FRONT SIGHT
22	MAGAZINE RELEASE	48	REAR SIGHT
23	MAGAZINE RELEASE SPRING	49	REAR SIGHT ADJUSTMENT KEY
24	MAGAZINE RELEASE PIN	50	TRIGGER
25	SLIDE RELEASE SPRING	51	FRONT TRIGGER ADJUSTMENT
26	SPRING SUPPORT PIN	52	REAR TRIGGER ADJUSTMENT

8.12.K12 SPORT EXPLODED WIEV

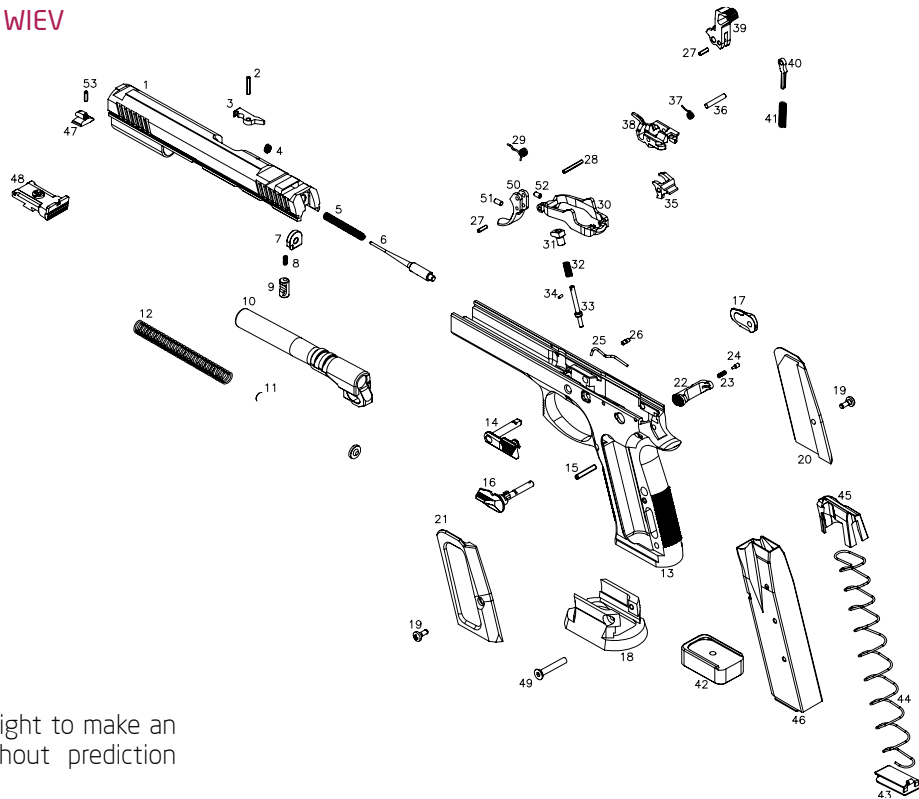

Note: Sarsılmaz reserves the right to make an amendment on features without prediction when it is needed.

PART LIST

NUMBER	PART NAME	NUMBER	PART NAME
1	SLIDE	28	TRIGGER AXLE
2	EXTRACTOR PIN	29	TRIGGER REBOUND SPRING
3	EXTRACTOR	30	TRIGGER BAR
4	EXTRACTOR SPRING	31	TRIGGER BAR LONG PIN
5	FIRING PIN SPRING	32	GUIDE SPRING
6	FIRING PIN	33	GUIDE PIN
7	FIRING CATCH	34	GUIDE SPRING LOCK PIN
8	FIRING PIN BLOCK SPRING	35	SEAR
9	FIRING PIN RETAINER	36	SEAR PIN
10	BARREL	37	SEAR SPRING
11	RECOIL SPRING GUIDE	38	EJECTOR
12	RECOIL SPRING	39	HAMMER
13	FRAME	40	HAMMER STRUT
14	SLIDE RELEASE	41	HAMMER SPRING
15	HAMMER STRUT PIN	42	MAGAZINE FLOOR PLATE
16	SAFETY LEVER (LEFT)	43	MAGAZINE INSERT
17	SAFETY LEVER (RIGHT)	44	MAGAZINE SPRING
18	BOTTOM GRIP	45	FOLLOWER
19	GRIP SCREW	46	MAGAZINE TUBE
20	RIGHT GRIP	47	FRONT SIGHT
21	LEFT GRIP	48	REAR SIGHT
22	MAGAZINE RELEASE	49	BOTTOM GRIP SCREW
23	MAGAZINE RELEASE SPRING	50	TRIGGER
24	MAGAZINE RELEASE PIN	51	FRONT TRIGGER ADJUSTMENT
25	SLIDE RELEASE SPRING	52	REAR TRIGGER ADJUSTMENT
26	SPRING SUPPORT PIN	53	FRONT SIGHT SCREW
27	TRIGGER&HAMMER PIN		

8.13. KILINÇ 2000 LIGHT EXPLODED VIEW

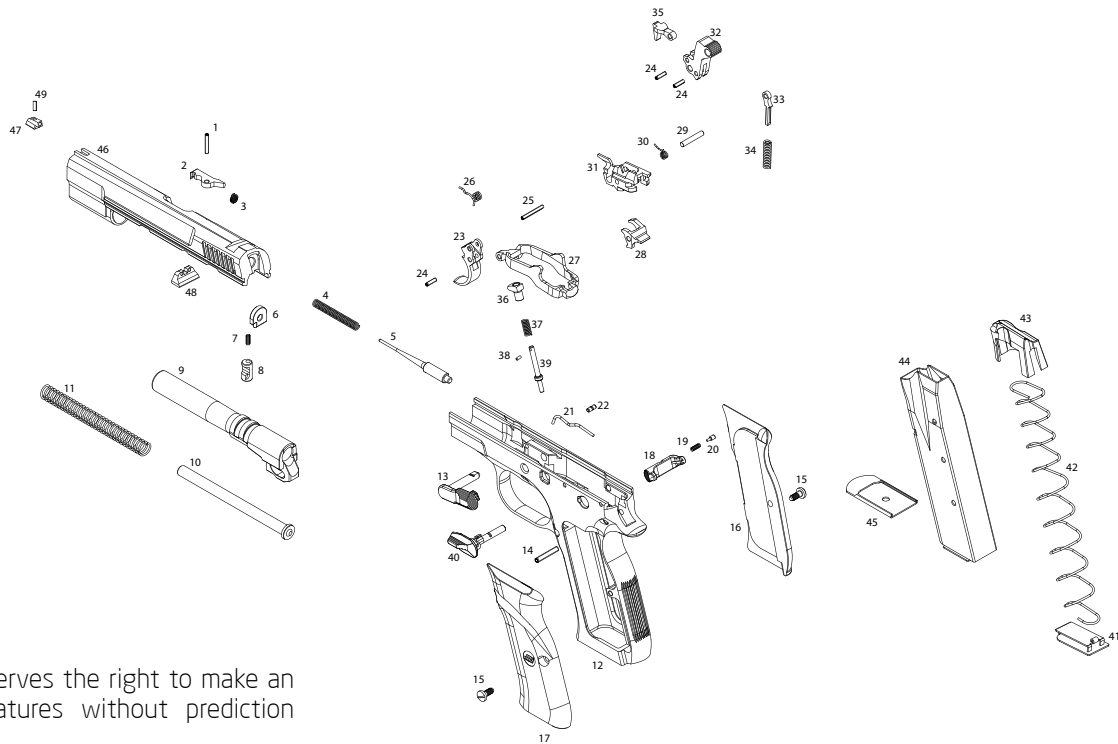

Note: Sarsılmaz reserves the right to make an amendment on features without prediction when it is needed.

PART LIST

NUMBER	PART NAME	NUMBER	PART NAME
1	EXTRACTOR PIN	26	TRIGGER REBOUND SPRING
2	EXTRACTOR	27	TRIGGER BAR
3	EXTRACTOR SPRING	28	SEAR
4	FIRING PIN SPRING	29	SEAR PIN
5	FIRING PIN	30	SEAR SPRING
6	FIRING PIN STOP	31	SEAR HOUSING
7	FIRING PIN RETAINER SPRING	32	HAMMER
8	FIRING PIN RETAINER	33	HAMMER STRUT
9	BARREL	34	HAMMER SPRING
10	RECOIL SPRING GUIDE	35	HAMMER CLAMP
11	RECOIL SPRING	36	TRIGGER BAR GUIDE
12	FRAME	37	GUIDE SPRING
13	SLIDE RELEASE	38	GUIDE SPRING LOCK PIN
14	HAMMER STRUT PIN	39	GUIDE PIN
15	GRIP SCREW	40	SAFETY LEVER
16	GRIP-R	41	MAGAZINE BUTTPLATE CATCH
17	GRIP-L	42	MAGAZINE SPRING
18	MAGAZINE RELEASE	43	FOLLOWER
19	MAGAZINE RELEASE SPRING	44	MAGAZINE TUBE
20	MAGAZINE RELEASE PIN	45	MAGAZINE BUTTPLATE
21	SLIDE RELEASE SPRING	46	SLIDE
22	SPRING SUPPORT PIN	47	FRONT SIGHT
23	TRIGGER	48	REAR SIGHT
24	TRIGGER&HAMMER PIN	49	FRONT SIGHT PIN
25	TRIGGER AXLE		

PART LIST

NUMBER	PART NAME	NUMBER	PART NAME
1	EXTRACTOR PIN	26	TRIGGER REBOUND SPRING
2	EXTRACTOR	27	TRIGGER BAR
3	EXTRACTOR SPRING	28	SEAR
4	FIRING PIN SPRING	29	SEAR PIN
5	FIRING PIN	30	SEAR SPRING
6	FIRING PIN STOP	31	SEAR HOUSING
7	FIRING PIN RETAINER SPRING	32	HAMMER
8	FIRING PIN RETAINER	33	HAMMER STRUT
9	BARREL	34	HAMMER SPRING
10	RECOIL SPRING GUIDE	35	HAMMER CLAMP
11	RECOIL SPRING	36	TRIGGER BAR GUIDE
12	FRAME	37	GUIDE SPRING
13	SLIDE RELEASE	38	GUIDE SPRING LOCK PIN
14	HAMMER STRUT PIN	39	GUIDE PIN
15	GRIP SCREW	40	SAFETY LEVER
16	GRIP-R	41	MAGAZINE BUTTPLATE CATCH
17	GRIP-L	42	MAGAZINE SPRING
18	MAGAZINE RELEASE	43	FOLLOWER
19	MAGAZINE RELEASE SPRING	44	MAGAZINE TUBE
20	MAGAZINE RELEASE PIN	45	MAGAZINE BUTTPLATE
21	SLIDE RELEASE SPRING	46	SLIDE
22	SPRING SUPPORT PIN	47	FRONT SIGHT
23	TRIGGER	48	REAR SIGHT
24	TRIGGER&HAMMER PIN	49	FRONT SIGHT PIN
25	TRIGGER AXLE		



SARSILMAZ®

Head Office

Burhaniye Mah. Kanuni Sultan Süleyman Sk. Mabeyin Konakları Sitesi Villa C 34676
Üsküdar/İSTANBUL - TÜRKİYE Tel: +90 216 266 44 00 - 10 Fax: +90 216 557 54 83

Manufacturer Factory

Sarsilmaz Silah Sanayi A.Ş.

Organize Sanayi Bölgesi 5. Cd. No: 20 81600 Beyköy/DÜZCE - TÜRKİYE
Tel: +90 380 548 80 11 - Fax: +90 380 548 85 63

Showroom Ankara

Mebus Evleri Mah. Döğol Cd. Meçhul Asker Sk. No. 18/2 ANKARA - TÜRKİYE
Tel: +90 312 213 19 99 - Fax : +90 312 213 03 19

Authorized Service and Spare Parts Supply Station

Sarsilmaz Silah Sanayi A.Ş.

Organize Sanayi Bölgesi 5. Cd. No: 20 81600 Beyköy/DÜZCE - TÜRKİYE
Tel: +90 380 548 80 11 - Fax: +90 380 548 85 63

www.sarsilmaz.com | sarsilmaz@sarsilmaz.com